

SITE ENGINEERING

The Hartford Team
 450 Church Street-Hartford-Connecticut-06103

Jeter, Cook & Jepson Architects, Inc.
 Tai Soo Kim Partners
 Smith Edwards Architects
 Clark/Tamaccio Architects
 Vanasse Hangen Brustlin, Inc.
 Macchi Engineers, LLC
 vanZelm Heywood & Shadford, Inc.

VHB
 Vanasse Hangen Brustlin, Inc.

Transportation
 Land Development
 Environmental Services
 54 Tuttle Place
 Middletown, CT 06457
 860 632 1500 • FAX 860 632 7879

P.C.
 P.M.
 D.P.
 J.C.

ISSUE 7/6/98
 JOB KAS
 SCALE 1"=40'

Site
 Grading
 Plan

SE-4

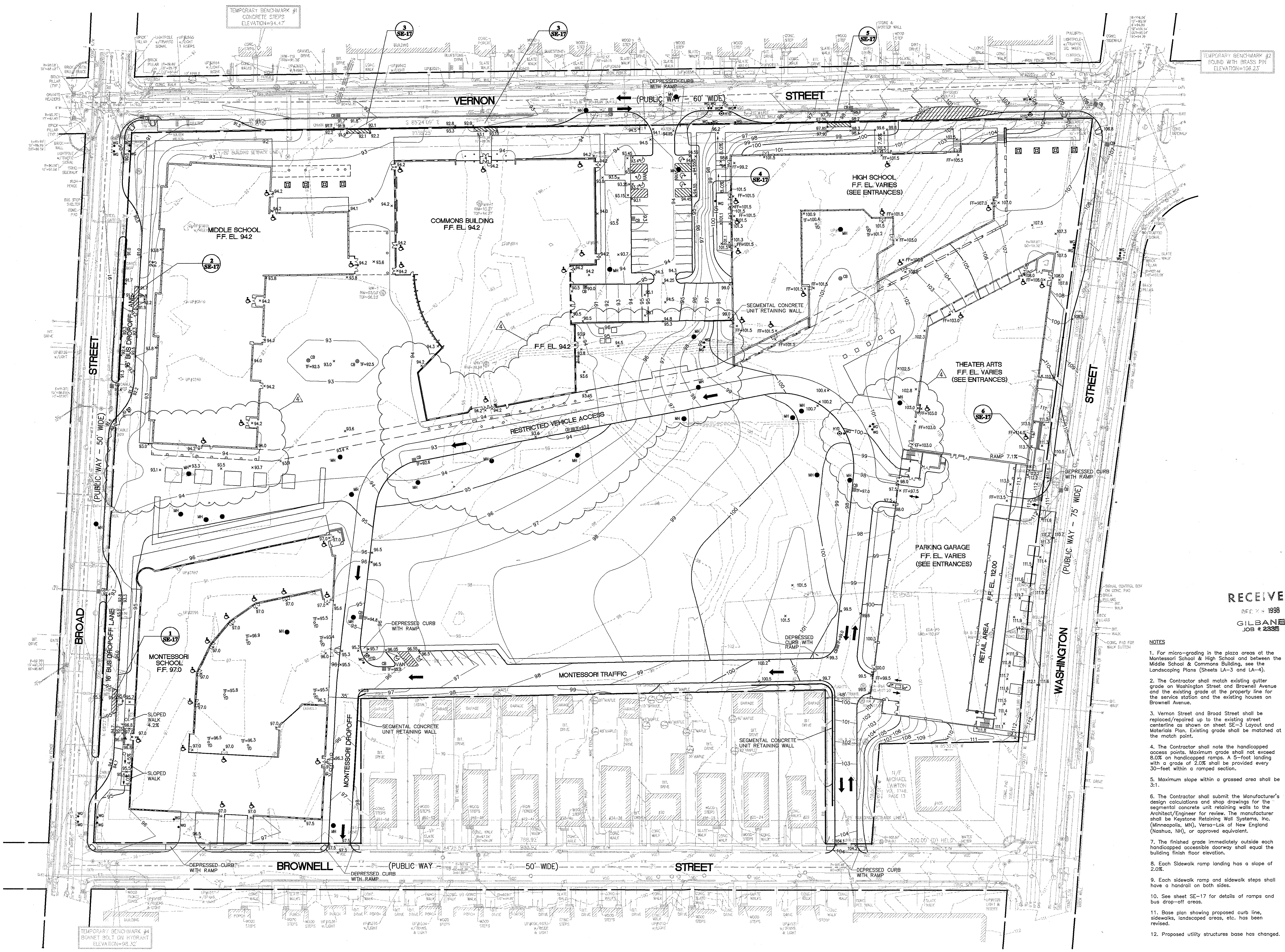

RECEIVED
 JUN 24 1998
 GILBANE
 JOB # 2335

- NOTES
1. For micro-grading in the plaza areas at the Montessori School & High School and between the Middle School & Commons Building, see the Landscaping Plans (Sheets LA-3 and LA-4).
 2. The Contractor shall match existing gutter grade on Washington Street and Brownell Avenue and the existing grade at the property line for the service station and the existing houses on Brownell Avenue.
 3. Vernon Street and Broad Street shall be replaced/repaired up to the existing street centerline as shown on sheet SE-3 Layout and Materials Plan. Existing grade shall be matched at the match point.
 4. The Contractor shall note the handicapped access points. Maximum grade shall not exceed 8.0% on handicapped ramps. A 5-foot landing with a grade of 2.0% shall be provided every 30-feet within a ramped section.
 5. Maximum slope within a grassed area shall be 3:1.
 6. The Contractor shall submit the Manufacturer's design calculations and shop drawings for the segmental concrete unit retaining walls to the Architect/Engineer for review. The manufacturer shall be Keystone Retaining Wall Systems, Inc. (Minneapolis, MN), Versa-Lok of New England (Nashua, NH), or approved equivalent.
 7. The finished grade immediately outside each handicapped accessible doorway shall equal the building finish floor elevation.
 8. Each sidewalk ramp landing has a slope of 2.0%.
 9. Each sidewalk ramp and sidewalk shall have a handrail on both sides.
 10. See sheet SE-17 for details of ramps and bus drop-off areas.
 11. Base plan showing proposed curb line, sidewalks, landscaped areas, etc. has been revised.
 12. Proposed utility structures base has changed.

CADD INFORMATION: VERN-17.DWG
 FILE NAME: 40184.GRD
 DATE AND TIME PLOTTED: 12/16/98
 PLOTTED BY: KAS