

MAP REFERENCE:

- 1.) MAP ENTITLED, "THE GENERAL SITE PLAN NATIONAL DEFENSE HOUSING PROJECT-CONN. 3-4 HOUSING AUTHORITY OF THE CITY OF HARTFORD UNDER LOAN CONTRACT WITH THE UNITED STATES HOUSING AUTHORITY ASSOCIATED ARCHITECTS OF HARTFORD FOR NATIONAL DEFENSE HOUSING INC. SCALE 1"=100'-0" 1-3-41
- 2.) MAP ENTITLED, "MAP SHOWING LAND ACQUIRED FROM HARTFORD HOUSING AUTHORITY FLATBUSH AVENUE, SOUTH SIDE BY CITY OF HARTFORD SCALE: 1"=20' SEPT. 1973 CITY OF HARTFORD DEPARTMENT OF ENGINEERING DAYBOOK NO. 0104092."
- 3.) MAP ENTITLED, "MAP OF LAND RIGHTS ACQUIRED BY THE STATE OF CONNECTICUT FOR THE PARK RIVER (SOUTH BRANCH) STREAM CHANNEL IMPROVEMENT SOUTH BRANCH OF THE PARK RIVER WATERSHED PROGRAM FROM FLATBUSH AVE TO OLIVE ST. VICINITY HARTFORD, CONN SCALE: 1"=200' MAY 1976."
- 4.) MAP ENTITLED, "MONUMENTATION MAP-MAP OF LAND RIGHTS ACQUIRED BY THE STATE OF CONNECTICUT FOR THE PARK RIVER (SOUTH BRANCH) STREAM CHANNEL IMPROVEMENT SOUTH BRANCH OF THE PARK RIVER WATERSHED PROGRAM HARTFORD, CONNECTICUT SCALE: 1"=200' MAY 1976 MAP NO. 3 & PART OF 4."
- 5.) MAP ENTITLED, "MONUMENTATION MAP-MAP OF LAND RIGHTS ACQUIRED BY THE STATE OF CONNECTICUT FOR THE PARK RIVER (SOUTH BRANCH) STREAM CHANNEL IMPROVEMENT SOUTH BRANCH OF THE PARK RIVER WATERSHED PROGRAM HARTFORD, CONNECTICUT SCALE: 1"=200' MAY 1976 MAP NO. 6 & PART OF 4."

DEED DESCRIPTION

JOB CORPS. PARCEL

BEGINNING AT A POINT, SAID POINT BEING A POINT OF TANGENCY ON THE WESTERN SIDE OF THE PARK RIVER (SOUTH BRANCH) EASEMENT BEING FURTHER BOUNDED AND DESCRIBED AS FOLLOWS:

THENCE, S89°58'22"W A DISTANCE OF 884.65 FEET TO A POINT;
THENCE, S00°01'38"E A DISTANCE OF 1215.13 FEET TO A POINT;
THENCE, ON ON A CURVE TO THE RIGHT, HAVING A DELTA ANGLE OF 24°01'30", A RADIUS OF 830.00, AND AN ARC LENGTH OF 348.03 FEET TO A POINT;
THENCE, N74°11'28"E A DISTANCE OF 324.43 FEET TO A POINT;
THENCE, ON ON A CURVE TO THE LEFT, HAVING A DELTA ANGLE OF 24°08'10", A RADIUS OF 640.00, AND AN ARC LENGTH OF 236.33 FEET TO A POINT;
THENCE, N49°13'18"E A DISTANCE OF 89.14 FEET TO A POINT;
THENCE, ON ON A CURVE TO THE LEFT, HAVING A DELTA ANGLE OF 65°52'30", A RADIUS OF 360.00, AND AN ARC LENGTH OF 413.90 FEET TO A POINT;
THENCE, N18°39'12"W A DISTANCE OF 432.88 FEET TO THE POINT AND PLACE OF BEGINNING.

SAID PARCEL CONTAINS 964,814.26 Square Feet or 22.15 Acres.

N/F STATE OF CONNECTICUT
DEPARTMENT OF AGRICULTURE

CERTIFICATION:

- 1.) THIS MAP AND SURVEY WERE PREPARED IN ACCORDANCE WITH THE "RECOMMENDED STANDARDS FOR SURVEYS AND MAPS IN THE STATE OF CONNECTICUT EFFECTIVE SEPTEMBER 26, 1996 PREPARED AND ADOPTED BY THE CONNECTICUT ASSOCIATION OF LAND SURVEYORS, INC. PURSUANT TO AND AS SET FORTH THESE STANDARDS. THE TYPE OF SURVEY PERFORMED AND THE MAPPED FEATURES DEPICTED HEREON ARE IN ACCORDANCE WITH THE REQUIREMENTS OF A BOUNDARY SURVEY. PROPERTY LINES, AS THEY ARE DEPICTED HEREON, PRESENT PROFESSIONAL OPINIONS THAT PERTAIN TO AN "INDEPENDENT RESURVEY". THIS MAP PRESENTS THE RESULTS OF MEASUREMENTS WHICH WERE MADE UPON THE GROUND IN ACCORDANCE WITH THE ACCURACY STANDARDS OF A CLASS A-2 SURVEY.
- 2.) THIS MAP AND SURVEY WERE PREPARED FOR CITY OF HARTFORD HOUSING AUTHORITY. TO BE USED IN MATTERS THAT RELATE TO THE BOUNDARY LINES. USE OF THIS MAP FOR OTHER PURPOSES OR BY OTHER PARTIES IS NOT AUTHORIZED OR VALID.

TO THE BEST OF MY KNOWLEDGE AND BELIEF THIS MAP IS SUBSTANTIALLY CORRECT AS NOTED HEREON.

PETER D. FLYNN CT.L.L.S. #8792 DATE 6/13/01
NOT VALID UNLESS ORIGINAL SIGNATURE, LIVE STAMP, & RAISED SEAL ARE AFFIXED.

FLYNN LAND SURVEYING ASSOCIATES
376 MILLBURN CHURCH HIGHWAY 688-7888
MILLBURN, CONNECTICUT 06037

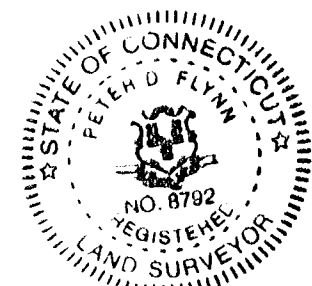

Flynn Land Surveying
Original ink
Drawing on Mylar

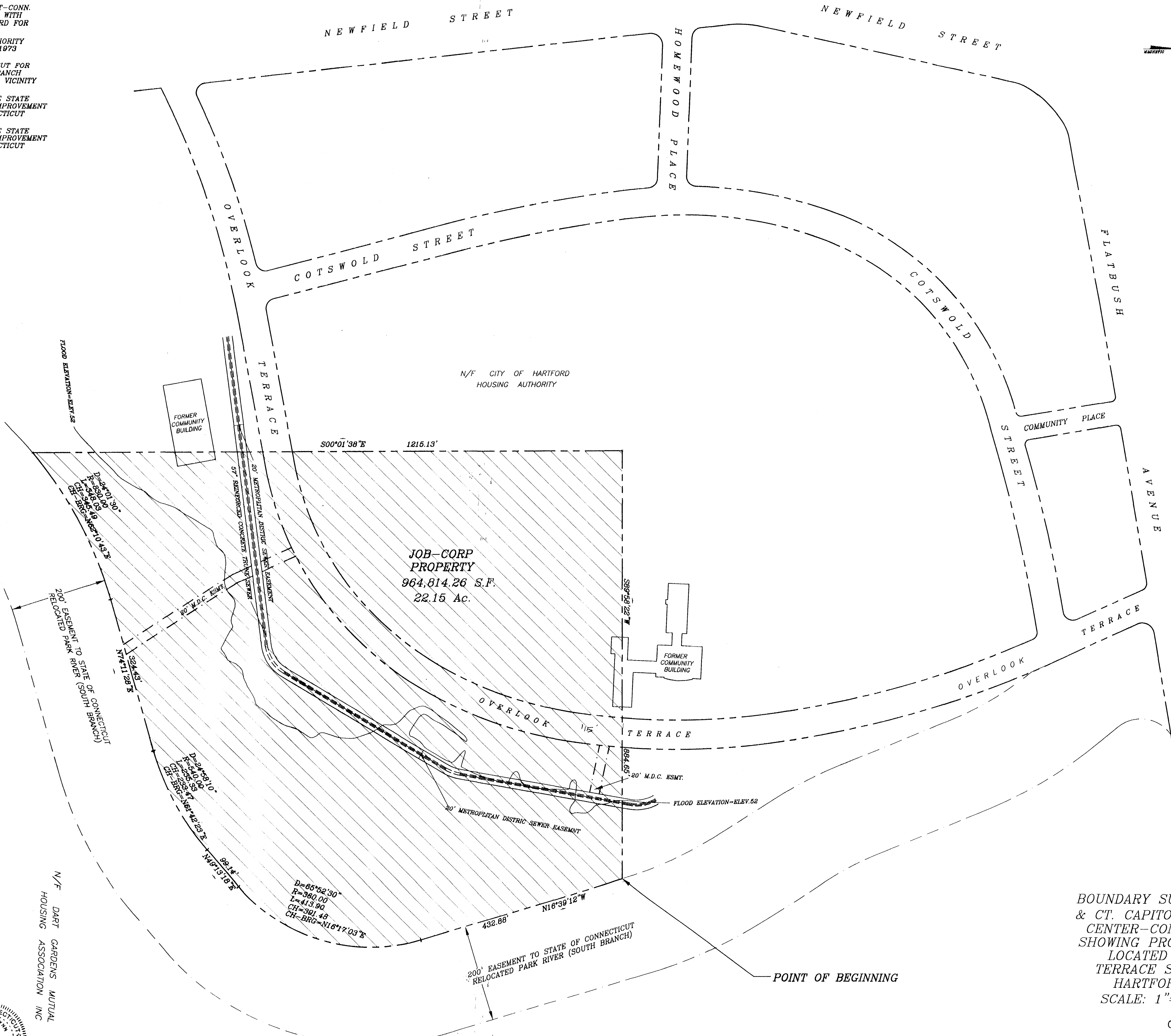

BOUNDARY SURVEY FOR DMJM/HTB
& CT. CAPITOL REGION JOB CORPS.
CENTER-CONNECTICUT COMMONS
SHOWING PROPERTY REALIGNMENT
LOCATED IN CHARTER OAK
TERRACE SECTIONS A, B, & C
HARTFORD, CONNECTICUT
SCALE: 1"=100' 6-08-2000

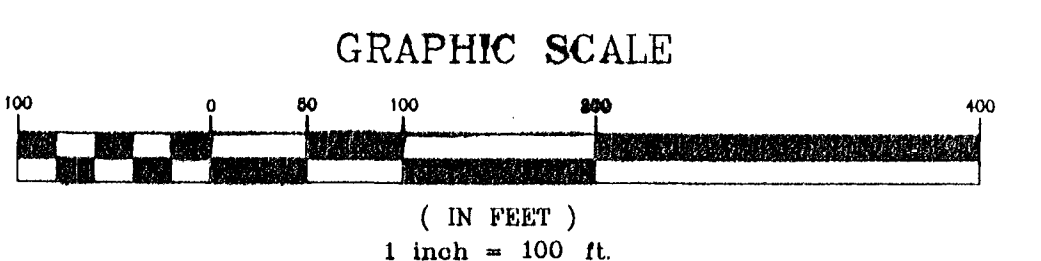

THE POINT OF BEGINNING IS NOT ON THE SUBJECT PARCEL
O. Burt
Survey Supervisor
6/15/01