

# LEGEND

	UTILITY POLE
	WATER GATE
	MANHOLE
	CATCH BASIN
	LIGHT STANDARD
	GAS GATE
	HYDRANT
	FENCE
	TREE
	STEEL GUIDE RAIL
	SPOT ELEVATION AT TOP OF STEPS
	SPOT ELEVATION AT BOTTOM OF STEPS
	SPOT ELEVATION
	UNDERGROUND STORM LINE
	UNDERGROUND TELEPHONE LINE
	UNDERGROUND ELECTRIC LINE
	UNDERGROUND WATER LINE
	UNDERGROUND GAS LINE
	UNDERGROUND SANITARY LINE

## MAP REFERENCES

- "CITY OF HARTFORD DEPT. OF PUBLIC WORKS, ENGINEERING-ASSESSOR PROPERTY MAP, SHEET #337, OCTOBER 1, 1984, SCALE 1"=50"
- "CITY OF HARTFORD, BLOCK CONTROL MAP, SHEET 337, SCALE 1"=50"
- "PROPOSED LAYOUT, RICHARD SHLOMBERG, HUNTINGTON STREET, HARTFORD, CONNECTICUT, SCALE 1"=30', AUG. 11, 1960, MORTON S. FINE, C.E.-L.S."
- "#199 COLLINS STREET, HARTFORD, CONNECTICUT, PLOT PLAN FOR AMAIO SAGAL, SCALE 1"=20', DATE 9/25/84, REVISED THROUGH 11-12-84, DRWG. NO. 6499, KENIG-FEINSTEIN ASSOCIATES, ENGINEERING AND LAND SURVEYING"
- "PLAN PREPARED FOR HUNTINGTON STREET LIMITED PARTNERSHIP 1988, NO. 41 HUNTINGTON STREET, HARTFORD, CONN., BOUNDARY SURVEY, SCALE 1"=20', DATE 5-23-86, FILE NO. 86587, SHEET NO. 1 OF 1, MEEHAN ASSOCIATES, CONSULTING ENGINEERS-SURVEYORS, P.C."
- "PROPERTY OF 63 HUNTINGTON ASSOCIATES LIMITED PARTNERSHIP, HUNTINGTON STREET & COLLINS STREET, TOWN OF HARTFORD, CT., SCALE: 1"=20', DATE 11-9-89, SHEET 1 OF 1, ALCA SURVEY ASSOCIATES, CARL H. JAEGER, L.S."
- "PROPERTY OF 195 SIGOURNEY ASSOCIATES LIMITED PARTNERSHIP, 195, 196, 198 SIGOURNEY STREET, TOWN OF HARTFORD, CONNECTICUT, SCALE: 1"=20', DATE: 6/14/83, UPDATED 4/28/86, SHEET 1 OF 1, ALCA SURVEY ASSOCIATES, CARL H. JAEGER, L.S."

THIS DRAWING HAS BEEN PREPARED BASED, IN PART, ON INFORMATION PROVIDED BY OTHERS RELATING TO THE LOCATION OF UNDERGROUND SERVICES. WE CAN NOT VERIFY THE ACCURACY OF THIS INFORMATION AND SHALL NOT BE HELD RESPONSIBLE FOR ANY ERRORS OR OMISSIONS WHICH MAY BE INCORPORATED HEREIN AS A RESULT.

INDICATED UNDERGROUND UTILITIES ARE BASED ON AVAILABLE DATA. THE LOCATIONS ARE APPROXIMATE AND ALL UTILITIES MAY NOT BE SHOWN. CALL "CALL B-4-U DIG" AT 1-800-922-4455 PRIOR TO ANY EXCAVATION.

I HEREBY DECLARE THAT THIS MAP IS SUBSTANTIALLY CORRECT. THIS MAP AND SURVEY WERE PREPARED IN ACCORDANCE WITH THE STANDARDS OF A CLASS T-2 SURVEY AS DEFINED IN THE "RECOMMENDED STANDARDS FOR SURVEYS AND MAPS IN THE STATE OF CONNECTICUT" AS PREPARED AND ADOPTED BY THE CONNECTICUT ASSOCIATION OF LAND SURVEYORS, INC., ON SEPTEMBER 13, 1984 AND EFFECTIVE JANUARY 1, 1987.

SURVEYOR'S SIGNATURE *7-24-95* 14649  
DATE LICENSE NUMBER

I HEREBY DECLARE THAT THIS MAP IS SUBSTANTIALLY CORRECT. THIS MAP AND SURVEY WERE PREPARED IN ACCORDANCE WITH THE STANDARDS OF A CLASS A-2 SURVEY AS DEFINED IN THE "RECOMMENDED STANDARDS FOR SURVEYS AND MAPS IN THE STATE OF CONNECTICUT" AS PREPARED AND ADOPTED BY THE CONNECTICUT ASSOCIATION OF LAND SURVEYORS, INC., ON SEPTEMBER 13, 1984 AND EFFECTIVE JANUARY 1, 1987.

SURVEYOR'S SIGNATURE *7-24-95* 14649  
DATE LICENSE NUMBER

## NOTES:

- #5 REBAR TO BE SET AT ALL PROPERTY CORNERS UNLESS NOTED.
- ELEVATIONS ARE BASED ON USC & GS DATUM.

N/F  
190 SIGOURNEY  
STREET, INC.  
VOL.3455, PG.244

N/F  
195 SIGOURNEY STREET  
ASSOCIATES LIMITED  
PARTNERSHIP  
VOL.3500, PG.273

N/F  
NORTH SIGOURNEY  
ASSOCIATES LIMITED  
PARTNERSHIP  
VOL.2035, PG.246

N/F  
HUNTINGTON LIMITED  
PARTNERSHIP  
VOL.3094, PG.278

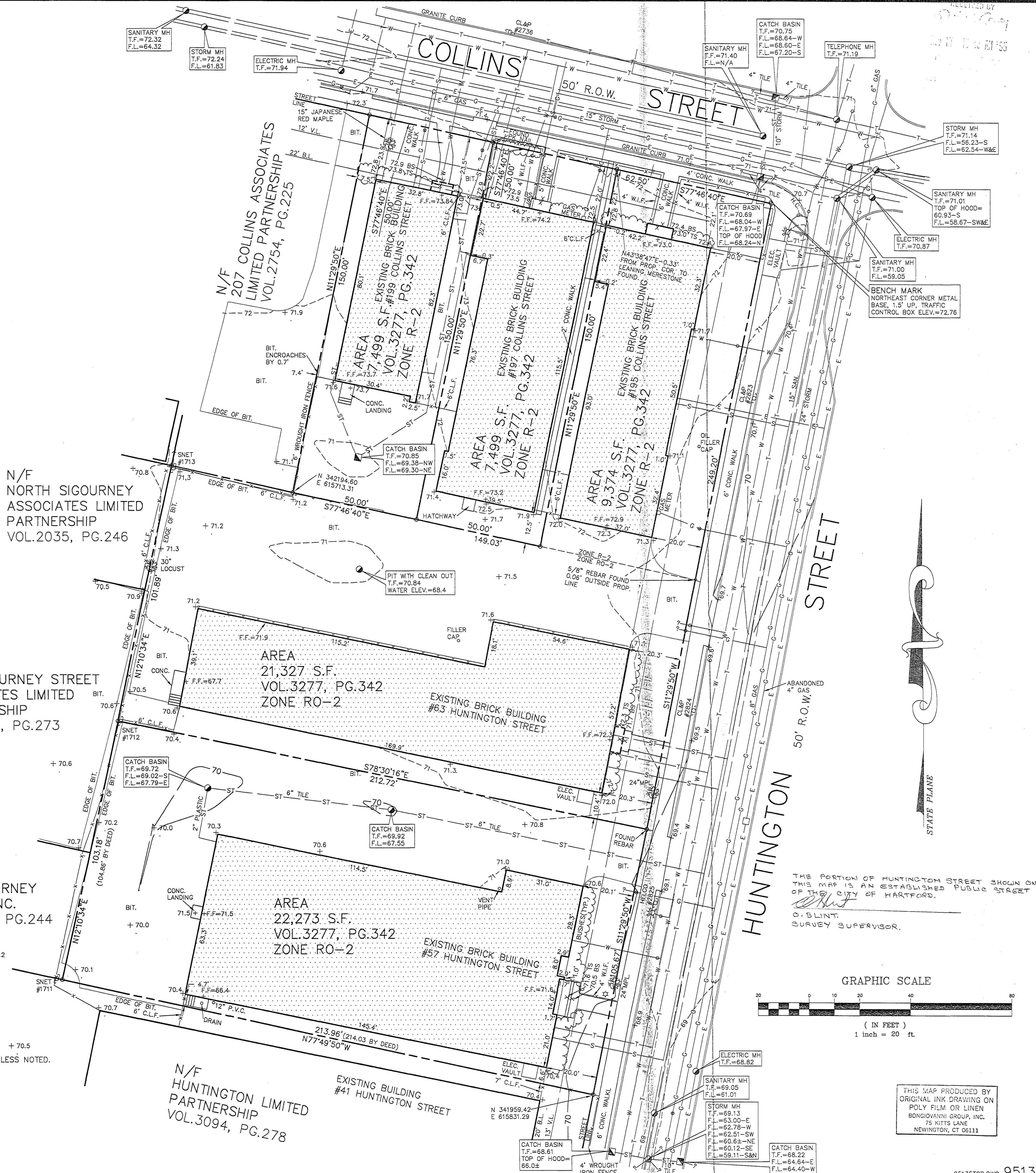

THE PORTION OF HUNTINGTON STREET SHOWN ON THIS MAP IS AN ESTABLISHED PUBLIC STREET

D. BLINT  
SURVEY SUPERVISOR

## GRAPHIC SCALE

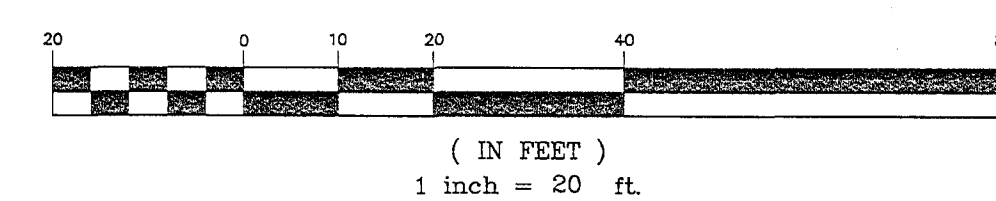

THIS MAP PRODUCED BY  
ORIGINAL INK DRAWING ON  
POLY FILM OR LINEN  
BONGIOVANNI GROUP, INC.  
75 KILLS LANE  
NEWINGTON, CT 06111

THE BONGIOVANNI GROUP, INC. (formerly W.E. Peters Assoc.) 75 KILLS LANE NEWINGTON, CONN. 06111 (203) 688-0134	
Date:	7-24-95
Drawn:	J.E.T.
Checked:	A.B.
Scale:	1"=20'
Revision:	
Date:	
General:	9-25-95
MAP OF PROPERTY OF FEDERAL HOME LOAN MORTGAGE CORPORATION 57 & 63 HUNTINGTON STREET AND 195, 197 & 199 COLLINS STREET HARTFORD, CONNECTICUT BOUNDARY & TOPOGRAPHIC SURVEY	
Sheet	1 of 1