

THE 3 POINT LINE SHALL BE THE SAME COLOR
AS THE FREE THROW LINE AND SEMICIRCLE.

NOTE: ALL LINES TO BE 2" WIDE

BASKETBALL COURT MARKING DETAIL

N.T.S.

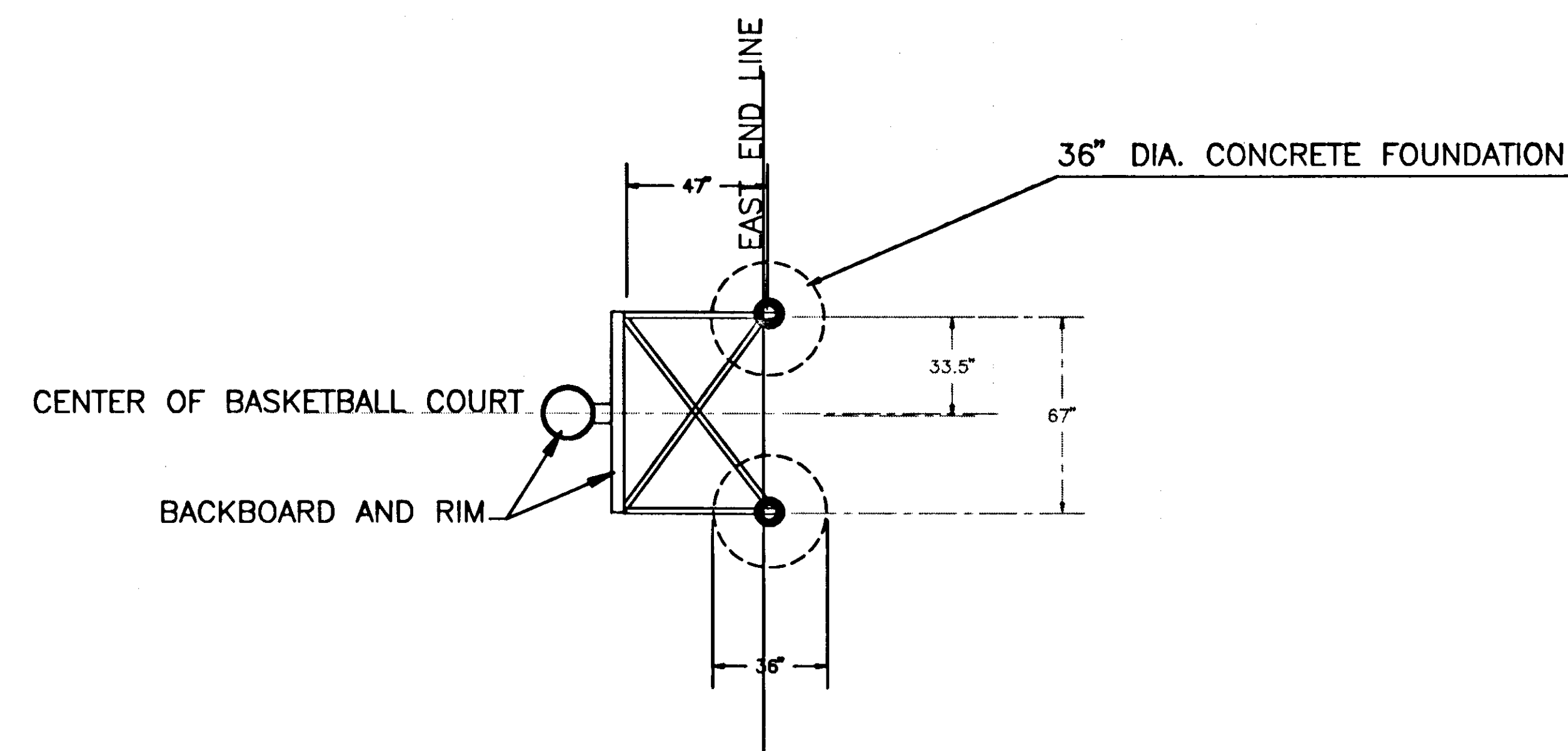

BASKETBALL STANDARD & FOUNDATION LAYOUT
N.T.S.

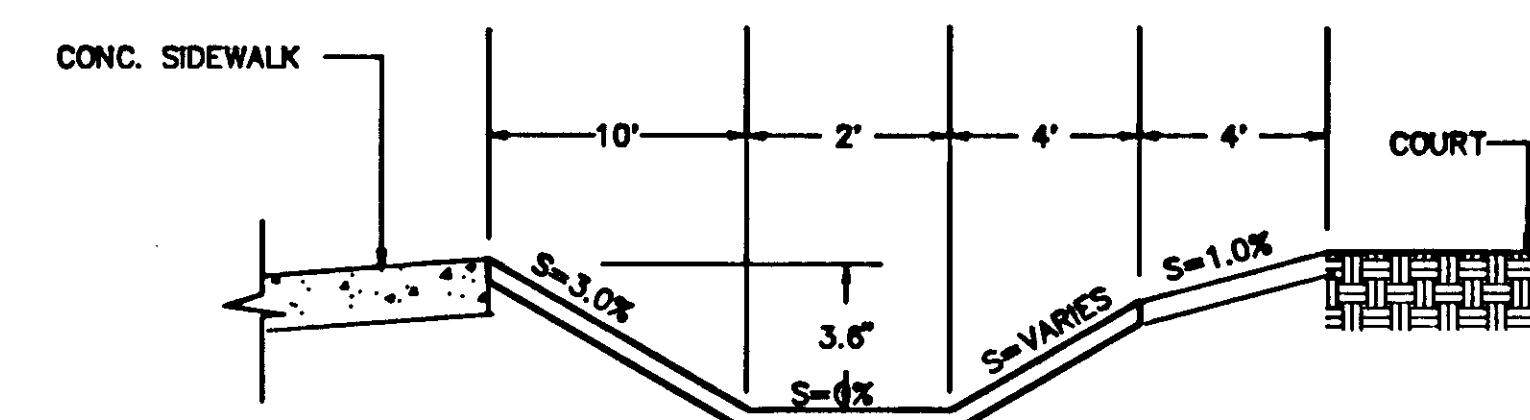

SECTION A-A DRAINAGE SWALE
N.T.S.

CITY OF HARTFORD, CONNECTICUT			
DEPARTMENT OF PUBLIC WORKS			
TRANSPORTATION SERVICES BUREAU			
PLAN TO DEVELOP			
PROPERTY AT 614-630 ALBANY AVENUE			
HARTFORD , CONNECTICUT			
SUBMITTED		RECOMMENDED	
_____		_____	
PROJECT ENGINEER		MANAGER	
_____		CITY ENGINEER	
DRAWN MK	SCALE:	DATEBOOK NO. 01397	
CHECKEDJS	NOT TO SCALE	DATE MAY 22, 1995	
		P.L.R. NAME ALRNY-RR.DWG	
		SHEET OF	