

FHWA REGION NO.	STATE	TOWN	FED. AID PROJ. NO.	PROJ. NO.	YEAR	ROUTE NO.	SHEET NO.	TOTAL SHEETS
1	CONN	HARTFORD	TEA-PEDS(40)	63-529	1999	-	4	58

PEDESTRIAN BRIDGE OVER COLUMBUS BOULEVARD
SIGN LAYOUT

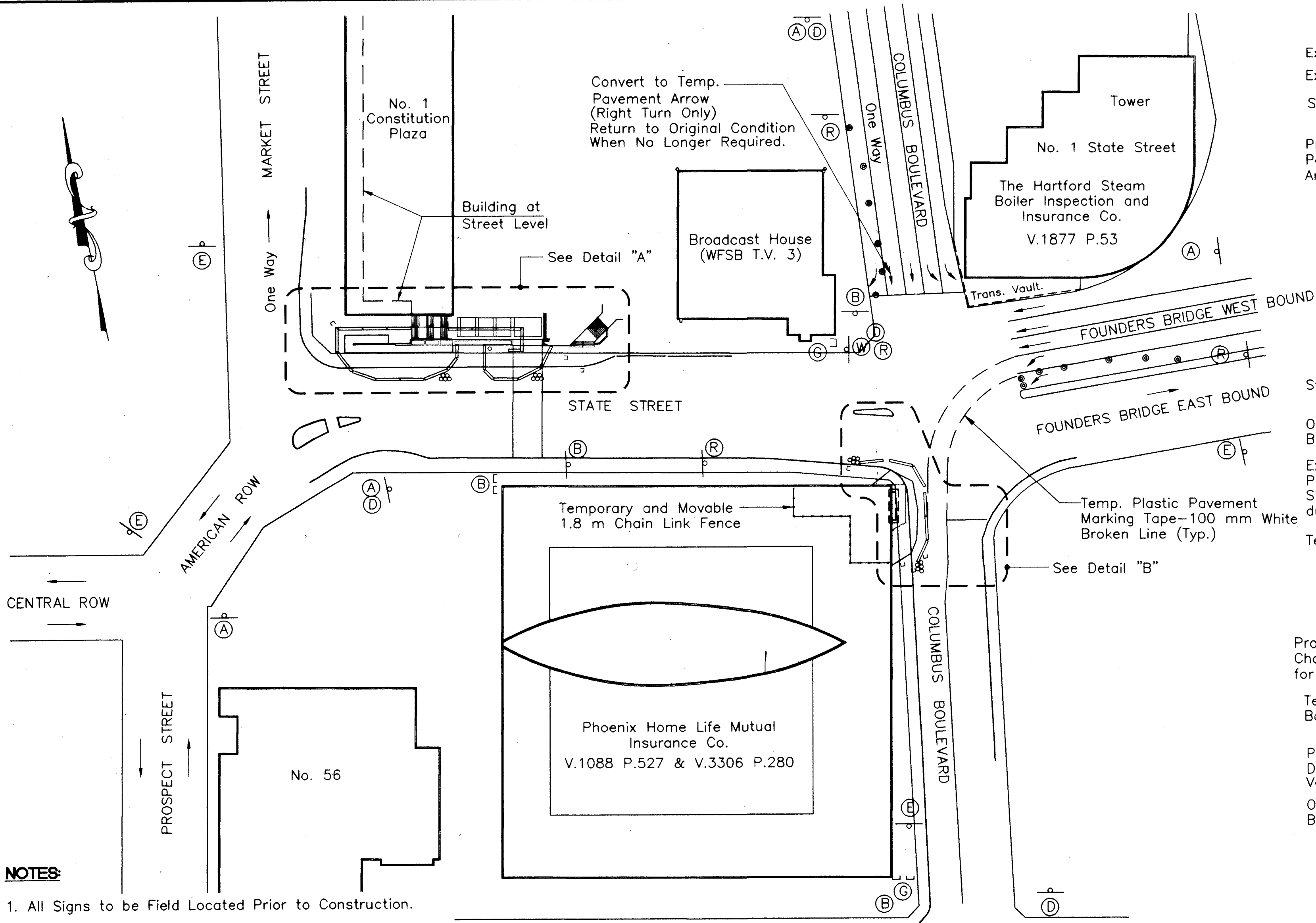

- NOTES:**
- All Signs to be Field Located Prior to Construction.
 - Existing signs in the project area which conflict with the temporary traffic control patterns shown on these plans, shall be covered, modified or removed and reset as directed by the Engineer. The cost thereof shall be included in the general cost of the project.
 - Contractor to take measures to ensure safety of pedestrians at all times utilizing a minimum of 1.5 m paved walkway.
 - Construction signs located on the roadway pavement or sidewalk, shall be attached to portable sign supports or 100 mm plastic signs/barricade supports either filled with sand or bagged to prevent movements. Construction barricades-Type III may be used on sidewalks.
 - For construction access, the Contractor may open a Temporary Precast Concrete Barrier Section at either end during each work day. The Barriers shall be fully closed as shown on the plan, at the end of each work day.
 - All signs must be coordinated with existing sign locations and with the Contractors operations under Proj. 63-376.
 - Existing Conflicting markings must be removed or covered as directed by the Engineer.
 - All dimensions shown are in millimeters, unless otherwise noted.
 - All elevations shown are in meters.
 - Due to ongoing construction under Project No. 63-376, existing conditions shown on these drawings may not accurately reflect actual conditions at the start of this project. The Contractor shall make any changes, as directed by the Engineer, necessary in order to maintain the safety of vehicular & pedestrian traffic during construction.

TRAFFIC PLAN
N.T.S.

GROVE STREET
One Way →

SIGN LEGEND			
LOCATION	TEXT	SIZE OF SIGN	SERIES
(A)	CONSTRUCTION AHEAD	1500 X 1050	See Sign 'A'
(B)	CONSTRUCTION AHEAD	1200 X 750	See Sign 'B'
(C)	ARROW	900 X 450	W1-6 80-1410
(D)	REDUCE SPEED TO 10 MPH	900	W13-1 80-3006
(E)	END CONSTRUCTION	1500 X 600	G20-2 80-1404
(R)	LANE ENDS MERGE LEFT	1200 X 1200	W9-2 80-2010
(F) (G)	SIDEWALK CLOSED ALL PEDESTRIANS	1200 X 760	See Sign 'F' & 'G'
(W)	(RIGHT LANE CLOSED)	1200	W4-2 80-2027

□ CONSTRUCTION BARRICADE (TYPE III)
▨ TEMPORARY PRECAST CONCRETE BARRIER
⊙ CONSTRUCTION CONES

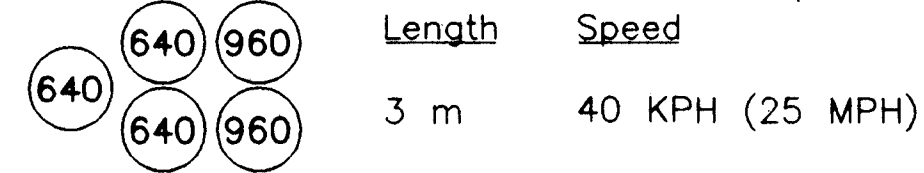
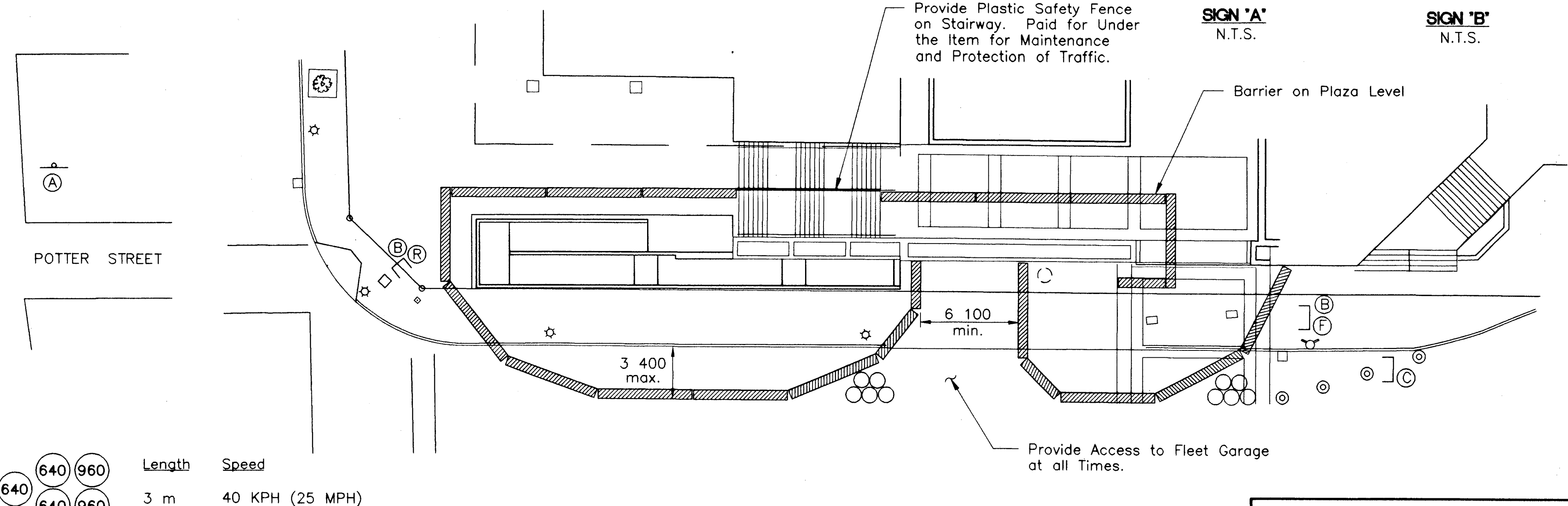
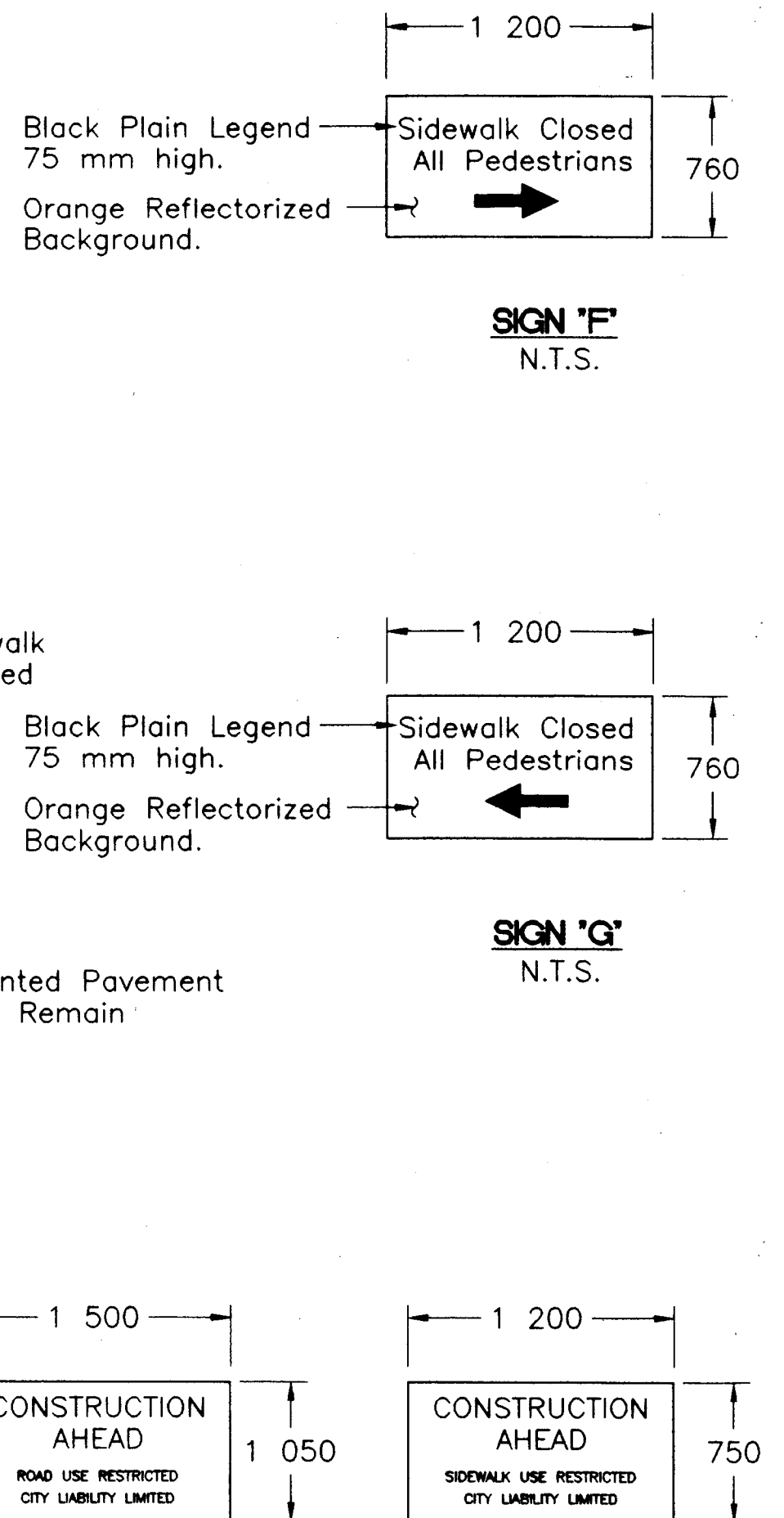
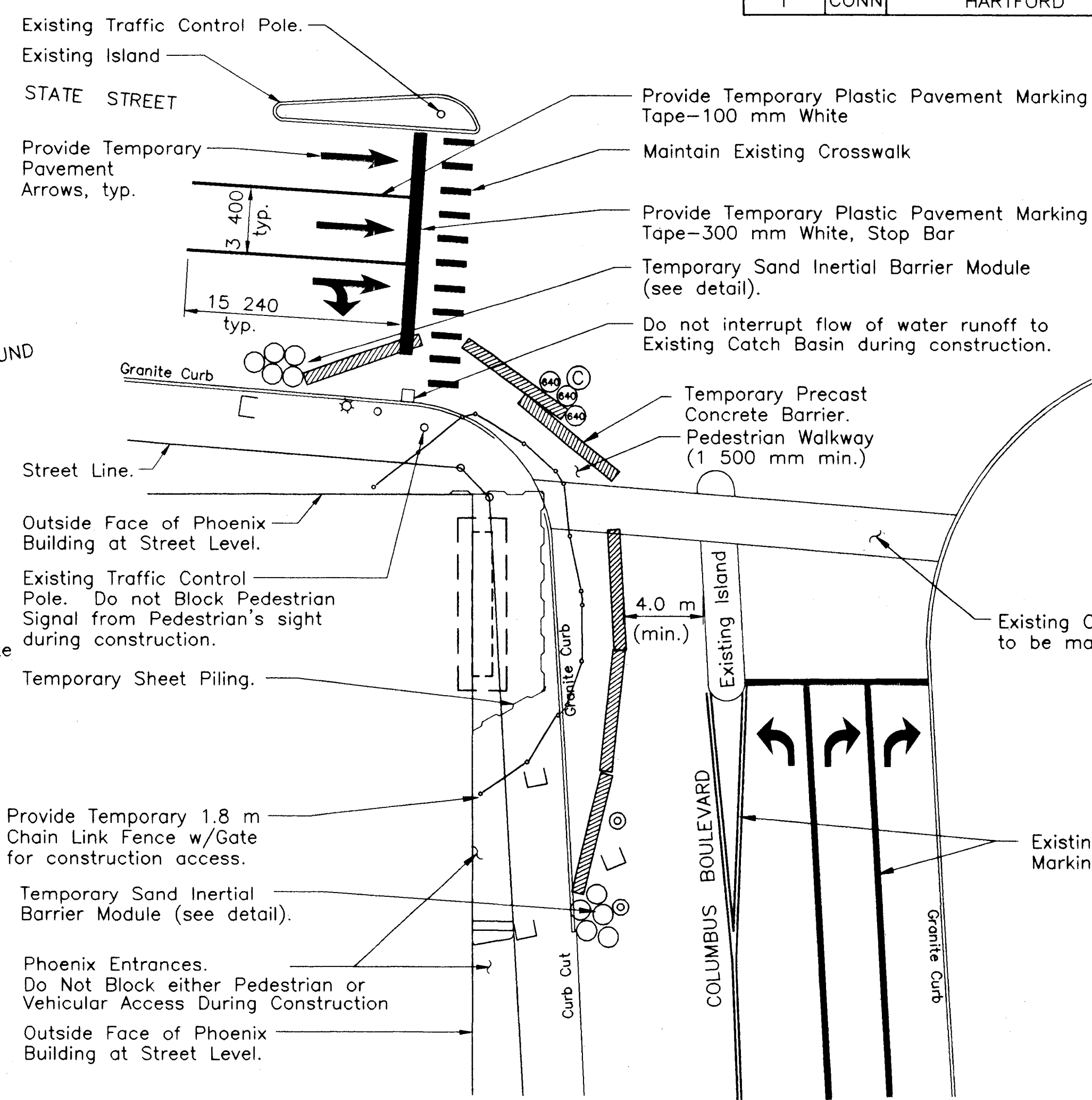

⊗ Sand Inertial Barrier Module. Numbers in Circles indicates Module Weight in kg.

TEMPORARY SAND INERTIAL BARRIER MODULE

REVISIONS			
NO	SHEET	DESCRIPTION	REV SHEET NO