

LINE STRIPING AND PAINT SCHEDULE			
CODE	COLOR	COATS	MATERIAL
A	LT. GREEN	2	FORTIFIED "PLEXIPAVE" 100% ACRYLIC COLOR SYSTEM OR APPROVED EQUAL
B	RED	2	FORTIFIED "PLEXIPAVE" 100% ACRYLIC COLOR SYSTEM OR APPROVED EQUAL
C	WHITE	2	HI-HIDE "PLEXICOLOR" LINE PAINT OR APPROVED EQUAL

NOTE: ONE (1) OF ACRYLIC RESURFACER SHALL BE APPLIED TO THE SURFACE PRIOR TO THE COLOR SYSTEM, AND ONE (1) COAT OF CLEAR-CO #5 AFTER THE COLOR SYSTEM AND LINE PAINT HAVE BEEN APPLIED.

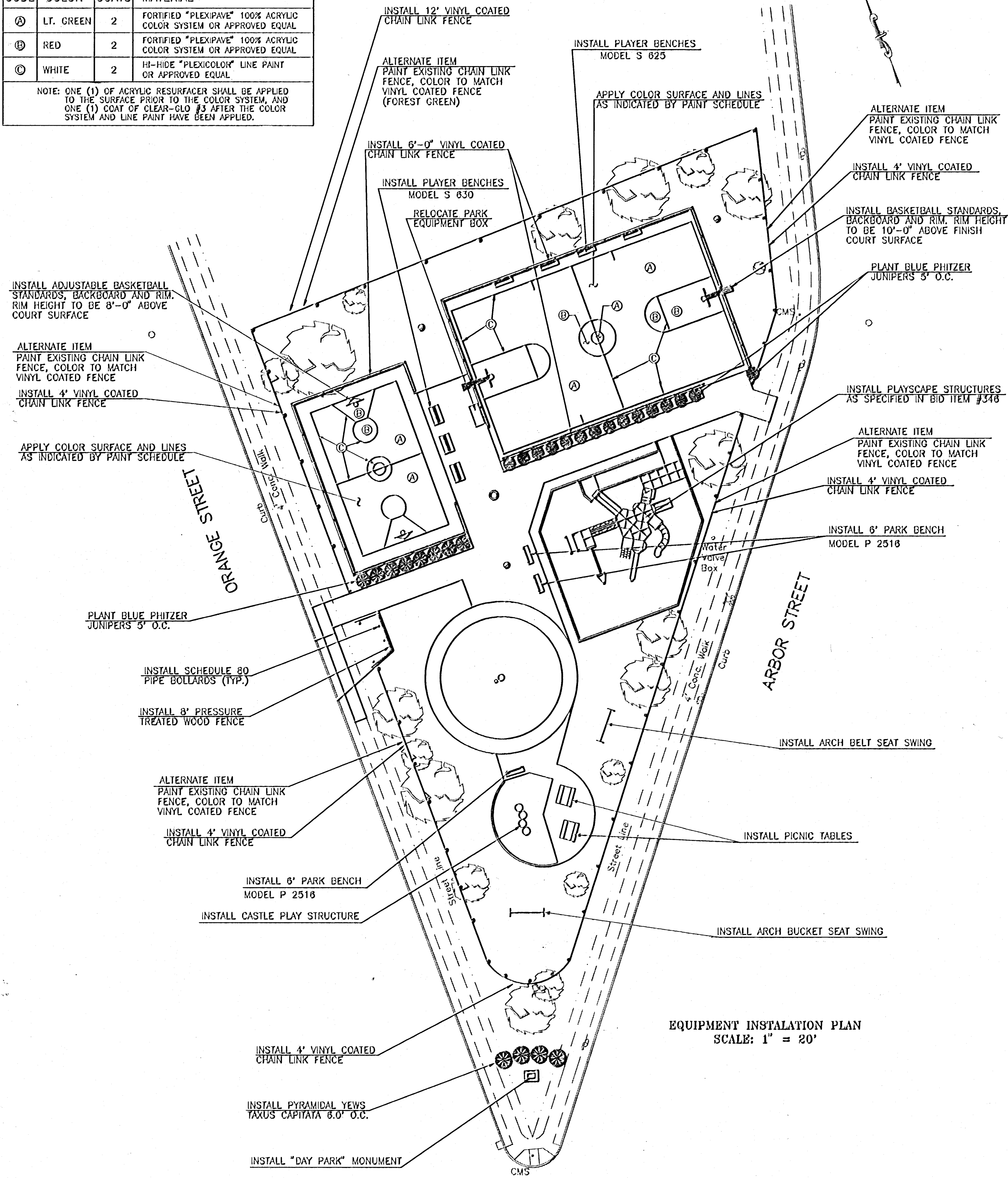

EQUIPMENT INSTALLATION PLAN
SCALE: 1" = 20'

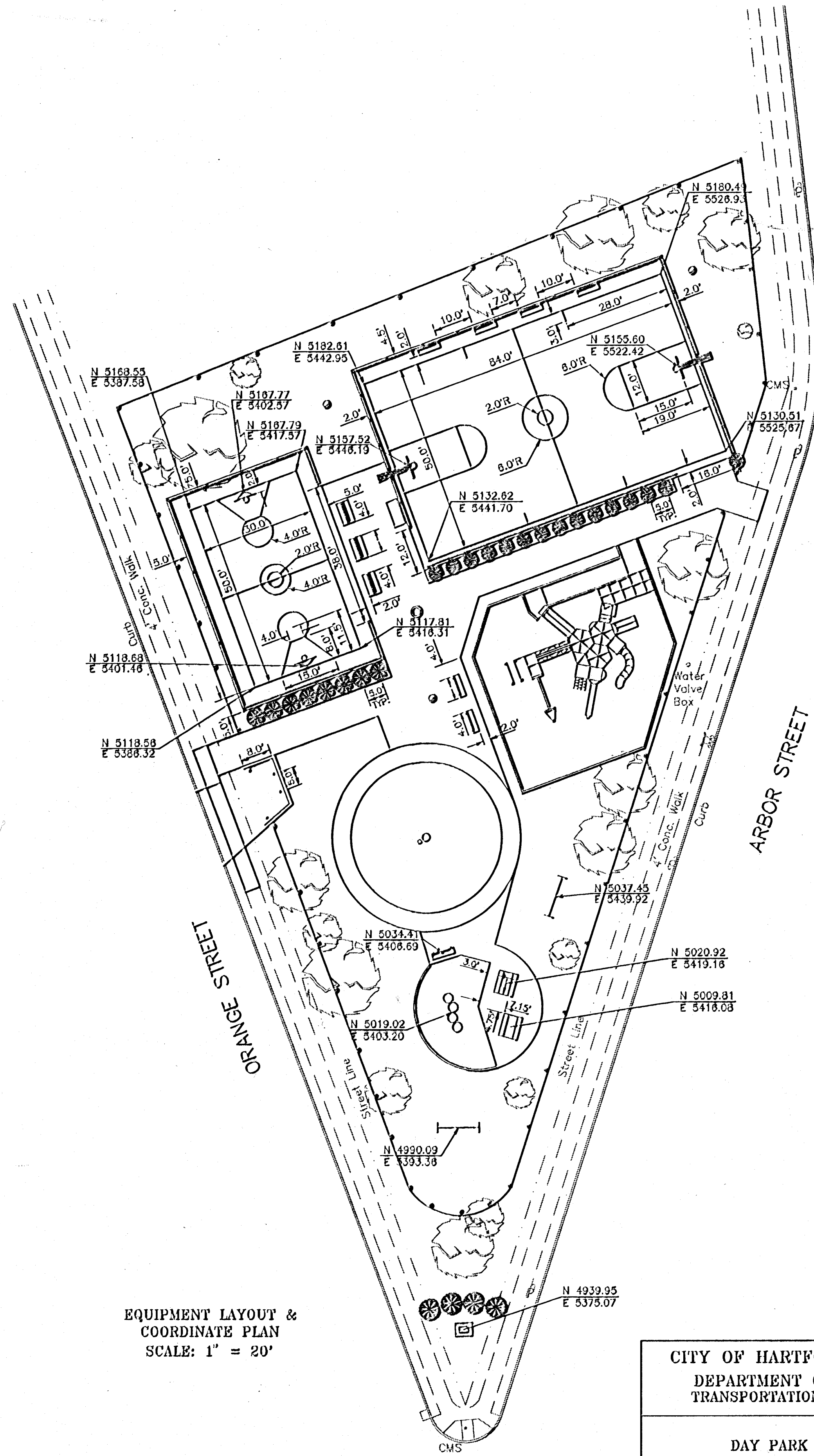

EQUIPMENT LAYOUT &
COORDINATE PLAN
SCALE: 1" = 20'

CITY OF HARTFORD, CONNECTICUT DEPARTMENT OF PUBLIC WORKS TRANSPORTATION SERVICES BUREAU			
DAY PARK IMPROVEMENTS EQUIPMENT INSTALLATION AND LOCATION COORDINATE PLAN			
SUBMITTED	RECOMMENDED	APPROVED	
PROJECT ENGINEER	MANAGER	CITY ENGINEER	
DRAWN <u>ROS</u>	SCALE: 1"=20'	DAYBOOK NO. 011330	SHEET 7
CHECKED		DATE SEPT. 1995	OF 7
		FILE NAME DAYP.DWG	