

| PROPERTY LEGEND | PLAN LEGEND | UTILITY LEGEND |
|---|------------------------------|--------------------------------------|
| Property Line | Guard Rail | Sanitary |
| Street Line | Edge of Water | Water |
| Stone Border Each Side | Wire Fence | Electric |
| Stone Border Monument | Stone Fence, Stone Wall | Gas |
| Iron Pin | Chain Link Fence | V.I. |
| Brass Pin | Utility Pole | R.C.P. |
| Heap of Stones | Manhole | Reinforced Concrete Pipe |
| Bell Hole | Catch Basin | C.N.P. |
| Fence Post | Ex. Spot Elevation | Corrugated Metal Pipe |
| Stake and Tack | Hydrant | Cast Iron |
| Traverse Point or P.I. of Curve | Evergreens | Copper |
| Found | Deciduous Trees | P.V.C. |
| Set | Watercourse | Polyethylene Chloride |
| Bench mark | Tree Line | B.I.T. |
| Computed | Lease | Concrete |
| Measured | Existing Contours | Top of Frame |
| Soiled | Proposed Contours | Invert |
| Assessors | Bi-tunious Concrete Lip Curb | Asphalt Coated Corrugated Metal Pipe |
| Existing | Ball of Ring | Head Wall |
| Proposed | Edge of Pavement | Light Pole |
| Angle Point in P.I. | Underground Electric | Valve Cover |
| Connecticut Highway Department Monument | Underground Gas | Utility Pole |
| | Underground Telephone | Underground |
| | Cut condition | Vent Pipe |
| | Front of Walk | Sign |
| | Back of Walk | |

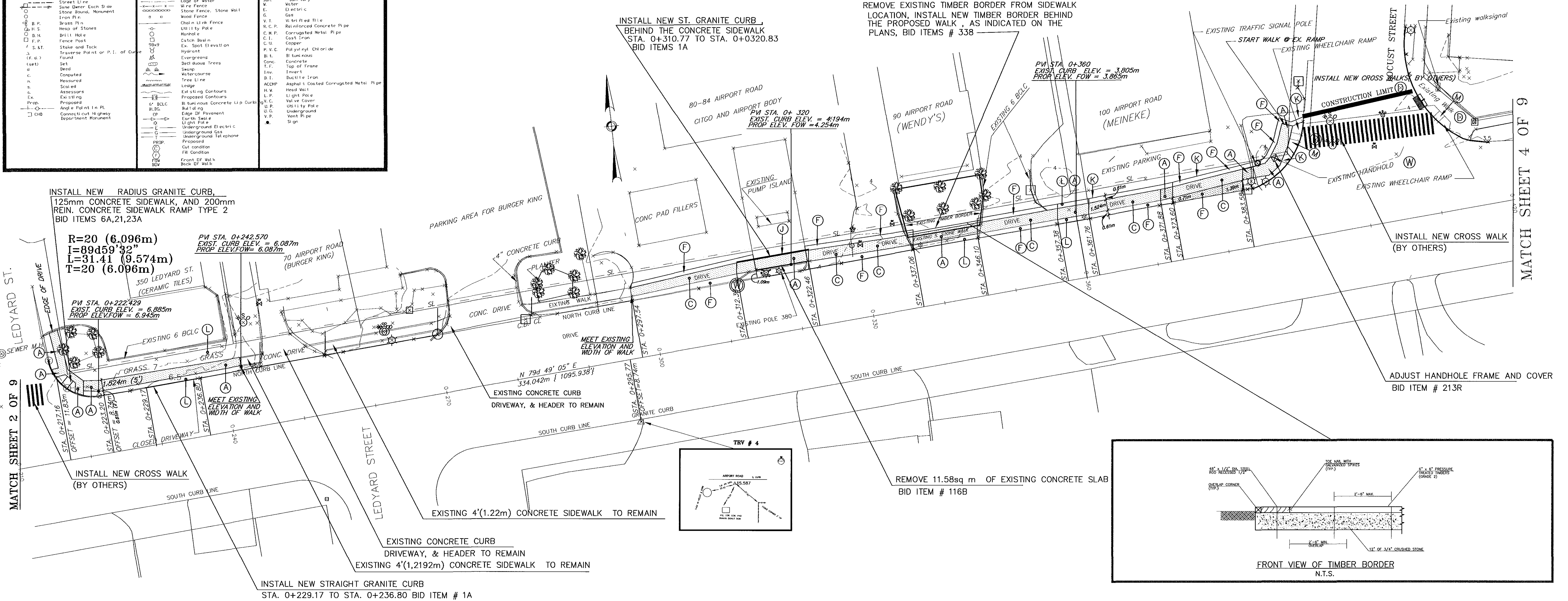

CONSTRUCTION NOTES:

1. ALL WORK SHALL BE COMPLETED IN ACCORDANCE WITH THE CONSTRUCTION PHASING PLAN. NO WORK SHALL BEGIN UNTIL ALL TRAFFIC CONTROL DEVICES ARE IN PLACE.
2. THE CITY RESERVES THE RIGHT TO ALTER, CHANGE, OR MODIFY THE TRAFFIC OR CONSTRUCTION PHASING PLANS IN THE INTEREST OF PUBLIC SAFETY.
3. ELEVATIONS ARE BASED ON M.D.C. DATUM AND ARE AS NOTED ON THE PLAN.
4. CATCH BASINS DAMAGED OR FILLED WITH DEBRIS DURING CONSTRUCTION SHALL BE CLEANED AT THE CONTRACTORS EXPENSE.
5. THE LOCATION OF EXISTING UTILITIES HAS BEEN OBTAINED FROM FIELD SURVEY AND RECORDED PLANS. THE CONTRACTOR SHALL BE RESPONSIBLE FOR VERIFYING THESE LOCATIONS IN THE FIELD AND TAKING ALL NECESSARY STEPS TO PROTECT THEM FROM DAMAGE. ANY UTILITY THAT IS DAMAGED THRU THE NEGLIGENCE OF THE CONTRACTOR SHALL BE REPAIRED BY THE CONTROLLING UTILITY COMPANY AT THE CONTRACTORS EXPENSE.
6. THE CONTRACTOR IS HEREBY REMINDED THAT TITLE 16 CHAPTER 293 OF THE CONNECTICUT GENERAL STATUTES REQUIRES NOTIFICATION TO UTILITY COMPANIES OF PENDING EXCAVATION AT OR NEAR PUBLIC UTILITIES. THE CONTRACTOR SHALL CALL 1-800-922-4455 AT LEAST 48 HOURS PRIOR TO EXCAVATION, BUT NOT MORE THAN 30 DAYS IN ADVANCE.
7. CONSTRUCTION LINE AND GRADE WILL BE PROVIDED TO THE CONTRACTOR BY THE CITY OF HARTFORD, DEPARTMENT OF PUBLIC WORKS. THE CONTRACTOR SHALL MAKE REQUEST FOR LINE AND GRADE BY CALLING TEL NO. 522-4888 EXT. 6585 AT LEAST 48 HOURS IN ADVANCE OF WORK. THE CONTRACTOR IS FURTHER REMINDED THAT ANY RE-STAKING THAT IS NECESSARY DUE TO THE CONTRACTORS NEGLIGENCE WILL BE BILLED FOR AT \$100.00 PER HOUR.
8. ANY PUBLIC OR PRIVATE PROPERTY DISTURBED AS A RESULT OF CONSTRUCTION OPERATIONS SHALL BE RESTORED AS QUICKLY AS POSSIBLE AND TO THE SATISFACTION OF THE ENGINEER.
9. THE CONTRACTOR SHALL BE RESPONSIBLE FOR NOTIFYING ADJACENT PROPERTY OWNERS OF IMPENDING CONSTRUCTION, AS WELL AS COORDINATING DRIVEWAY REMOVAL/REPLACEMENT WORK.
10. RIM OR FRAME ELEVATIONS OF ALL UTILITY STRUCTURE SHALL BE ADJUSTED TO MEET FINISHED PAVED SURFACES. PRIVATE UTILITIES WHO ARE RESPONSIBLE FOR ADJUSTING THEIR OWN STRUCTURES SHALL BE NOTIFIED WELL IN ADVANCE BY THE CONTRACTOR. PRIVATE UTILITIES WILL ADJUST THEIR STRUCTURES AT THEIR OWN EXPENSE.
11. STAGGING AREAS AND MATERIAL STOCK PILES SHALL BE LIMITED WITHIN THE SITE AND LOCATED SO AS NOT TO INTERFERE WITH PEDESTRIAN OR VEHICULAR TRAFFIC. THE CONTRACTOR SHALL PROVIDE SAFETY DEVICES (IF ORDERED BY THE CITY) TO PROTECT STOCK PILES/ WORK STAGGING AREAS. IF THIS WORK IS SO ORDERED THERE WILL BE NO ADDITIONAL COMPENSATION MADE TO THE CONTRACTOR.
12. HOURS OF WORK SHALL BE AS DEFINED IN THE CONTRACT DOCUMENTS. THE CITY RESERVES THE RIGHT TO ADJUST THESE HOURS IN THE INTEREST OF PUBLIC SAFETY.
13. EACH LAYER OF MATERIAL USED FOR BACKFILL OR SUBGRADE SHALL BE COMPACTED UNTIL THE DRY DENSITY OF EACH LAYER IS AT LEAST 95% OF THE DRY DENSITY ACHIEVED BY THE AASHTO TEST T180, METHOD D FOR THAT SOIL. MAXIMUM LAYER THICKNESS NOT TO EXCEED 305MM.
14. ACCESS TO PRIVATE PROPERTIES MUST BE MAINTAINED AT ALL TIMES. FOR SECURITY REASONS ALL PRIVATELY OWNED FENCING THAT IS TO BE REMOVED SHALL BE REPLACED WITHIN 72 HOURS OF REMOVAL.
15. CONTRACTOR SHALL TAKE A PRECAUTION ON ALL INTERSECTION ON POSSIBLE SHALLOW TRAFFIC SIGNAL APPARATUS. THE LOCATION OF SHALLOW CONDUITS SHALL BE VARIFIED PRIOR TO ANY EXCAVATION AND COORDINATED WITH THE TRAFFIC UNIT OF THE CITY OF HARTFORD.
16. CONTRACTOR SHALL NOTIFY D.O.T. PRIOR TO CONSTRUCTION, DISTRICT ONE, SURVEY UNIT, @ (860) 258-4590, BEFORE STARTING ANY WORK NEAR MERESTONE SO THAT DOT CAN SURVEY IT.
17. PRIOR TO ANY CONSTRUCTION, CONTRACTOR HAS TO APPLY FOR A PERMIT FROM STATE D.O.T. THE PERMIT SHALL BE SIGNED BY THE CITY PRIOR TO IT'S SUBMISSION TO D.O.T.
18. CONTRACTOR SHALL FURNISH PROOF OF INSURANCE CONSISTENT WITH STATE D.O.T. REQUIREMENTS AS STATED ON CONTRACT DOCUMENTS AND FURNISH INSURANCE CERTIFICATION A,B, &D CERTIFICATION A,B, &D AS FURTHER SPECIFIED ON THE CONTRACT DOCUMENTS

CITY OF HARTFORD, CONNECTICUT
DEPARTMENT OF PUBLIC WORKS
ENGINEERING SERVICES

SIDEWALK CONSTRUCTION PLANS FOR
AIRPORT ROAD AND BRAINARD ROAD
(AIRPORT ROAD STA. 0+210 TO STA. 0+420)

| | | |
|------------------|------------------------------|---------------|
| SUBMITTED | RECOMMENDED | APPROVED |
| PROJECT ENGINEER | MANAGER | CITY ENGINEER |
| DRAWN H.Y.O. | SCALE: 1=250m(H) 1=25m(V) | DATE |
| CHECKED BNP | FILE NAME | DATE |

| | |
|--------------------|--------------|
| DAYBOOK NO. 011311 | SHEET 3 OF 9 |
| AIRBRN1.DWG | |