

- CONSTRUCTION NOTES
1. (A) CONSTRUCT 3" BITUMINOUS CONCRETE ON NEW FOUNDATION.
 2. (B) SAWCUT BETWEEN EXISTING RAMPED SECTION AND SIDEWALK, AND CONSTRUCT NEW 8" REINFORCED CONCRETE DRIVEWAY RAMP.
 3. (C) EXISTING DRIVEWAY RAMP TO REMAIN.
 4. (D) CONSTRUCT 8" REINFORCED CONC. SIDEWALK.
 5. (E) CONSTRUCT 2" BITUMINOUS CONC. SURFACE ON NEW FOUNDATION, EXCEPT AT DRIVEWAYS AND RAMPS.
 6. (F) SEEDING, FERTILIZING AND MULCHING.
 7. (G) CONSTRUCT 8" REINFORCED CONC. DRIVEWAY RAMP.
 8. (H) CONSTRUCT BITUMINOUS CONCRETE DRIVEWAY.
 9. (I) RELAY FLAG STONE WALK.
 10. (J) CUT BITUMINOUS CONC. SURFACE.
 11. (K) RELAY BRICK WALK.
 12. (L) CONSTRUCT 5" CONCRETE SIDEWALK EXCEPT AT DRIVEWAYS.
2. ELEVATIONS ARE BASED ON METROPOLITAN DISTRICT COMMISSION (MDC) DATUM.
3. RIM OR FRAME ELEVATIONS OF ALL UTILITY CATCH BASINS, HANDHOLES, MANHOLES AND CATCH BASINS ARE TO BE ADJUSTED AS REQUIRED TO MATCH PROPOSED FINISHED PAVED SURFACES.
4. CALL BEFORE YOU DIG: THE CONTRACTOR IS HEREBY REMINDED THAT PURSUANT TO PUBLIC ACT 87-71 REQUIRES NOTIFICATION TO UTILITY COMPANIES OF PENDING EXCAVATION AT OR NEAR THE LOCATION OF PUBLIC UTILITIES. THE CONTRACTOR SHALL CALL THIS NUMBER 1-800-922-4455 AT LEAST 48 HOURS, EXCLUDING SATURDAYS, SUNDAYS AND HOLIDAYS, BUT NOT MORE THAN THIRTY DAYS (ONE MONTH) PRIOR TO EXCAVATION.
5. STATIONS MEASURED ON CENTER LINE AND ON SLOPE.
6. DRIVEWAY STATIONS ARE APPROXIMATE AND ARE SUBJECT TO CHANGE IF AUTHORIZED BY ENGINEER.
7. BENCH MARK STATION 17+29.88 IN FRONT OF 475 LEDYARD STREET ELEVATION=21.18'

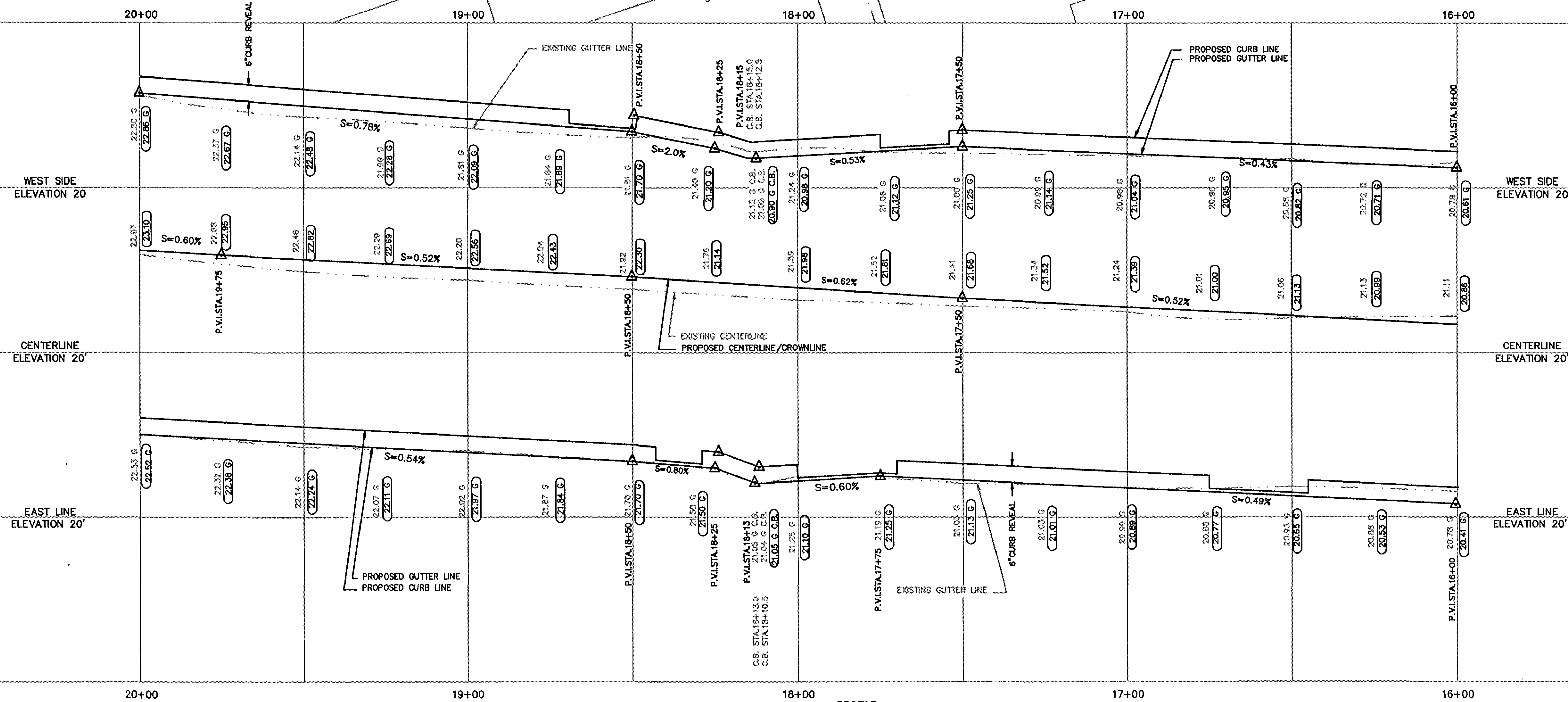

CITY OF HARTFORD, CONNECTICUT
DEPARTMENT OF PUBLIC WORKS
ENGINEERING SERVICES BUREAU

LEDYARD STREET
PLAN AND PROFILE
STATION 16+00 TO STATION 20+00

SUBMITTED <i>Manuel...</i>	RECOMMENDED <i>S. J. ...</i>	APPROVED <i>...</i>
PROJECT ENGINEER	DIVISION MANAGER	CITY ENGINEER
DRAWN <i>M.K.</i>	SCALE: HORIZ. 1"=20' VERT. 1"=2'	DAYBOOK NO. 011234E DATE JULY 1991 FILE NAME E01-09-5
CHECKED <i>M.K.</i>		SHEET 10 OF 12