

Detail/ Typical Panel

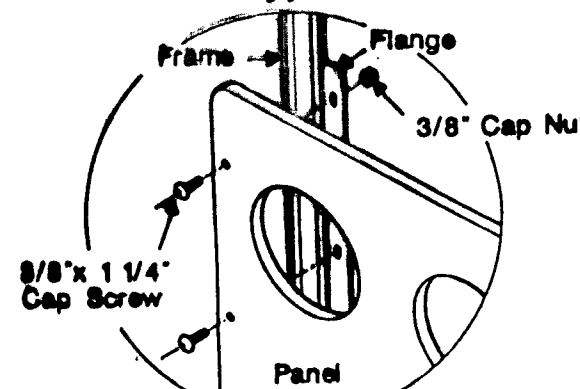

NOTE: Mount Panels On OUTSIDE OF Flange.

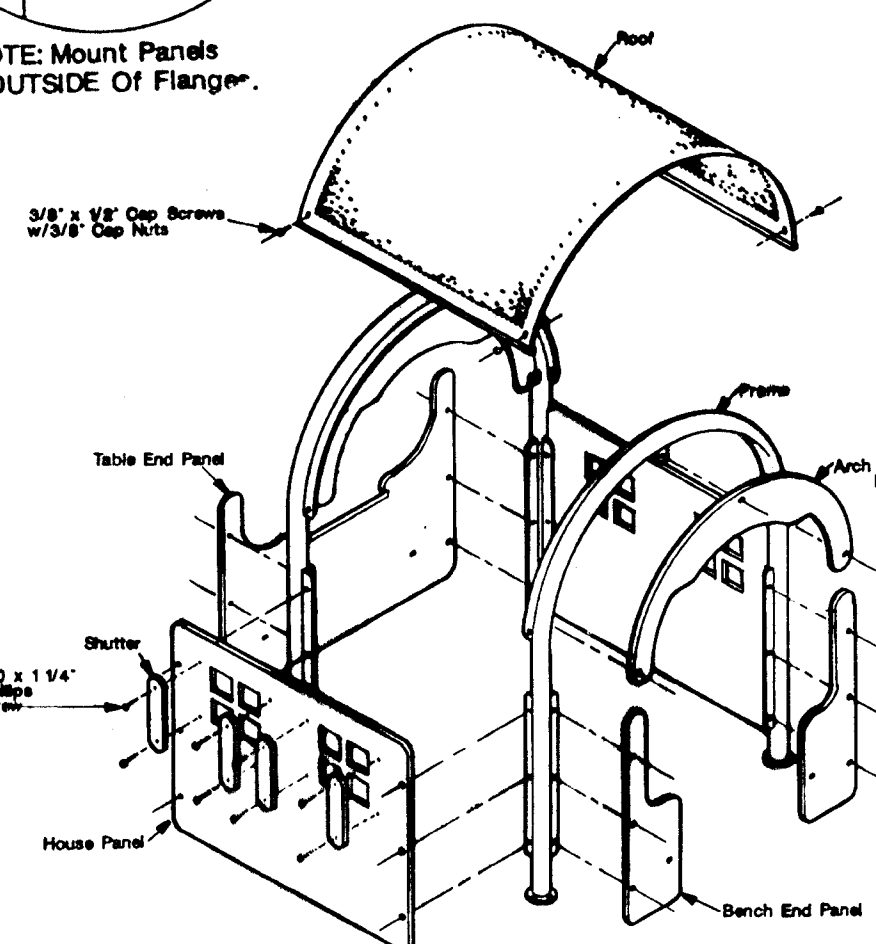

Bench Detail

Note A:
Drill 7/16" Hole from inside bench through Table End Panel.

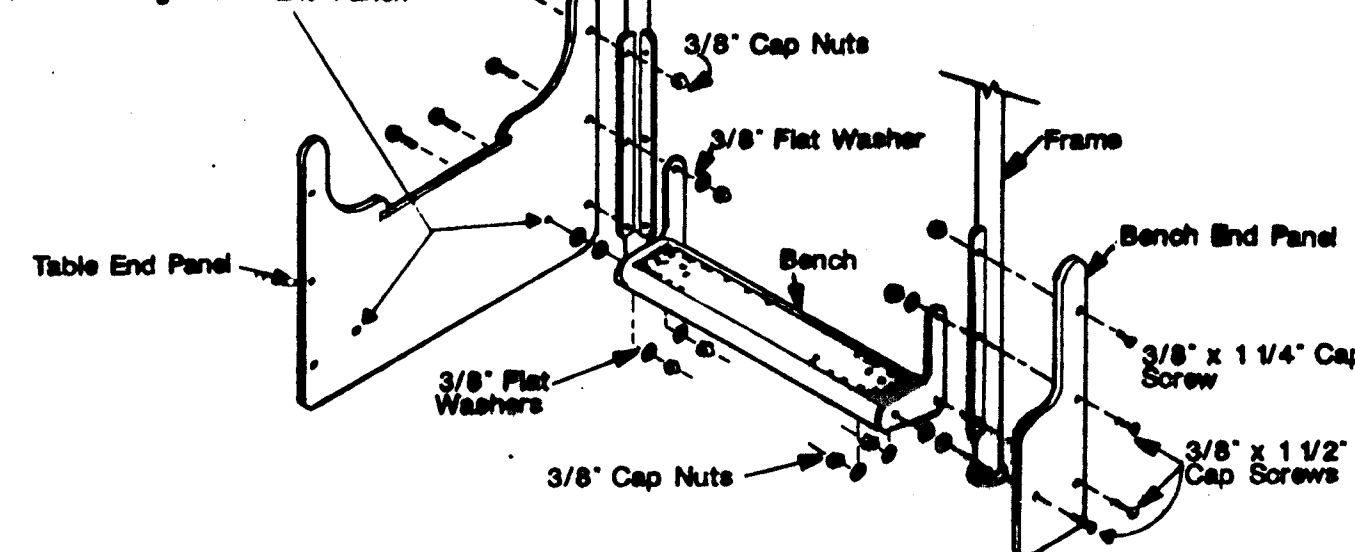
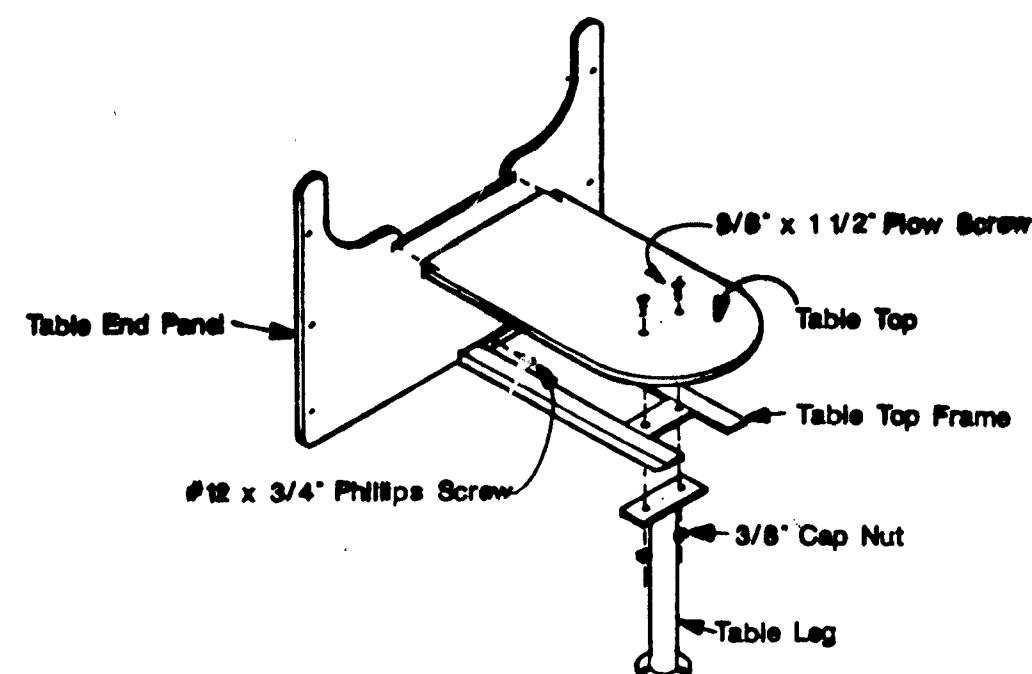
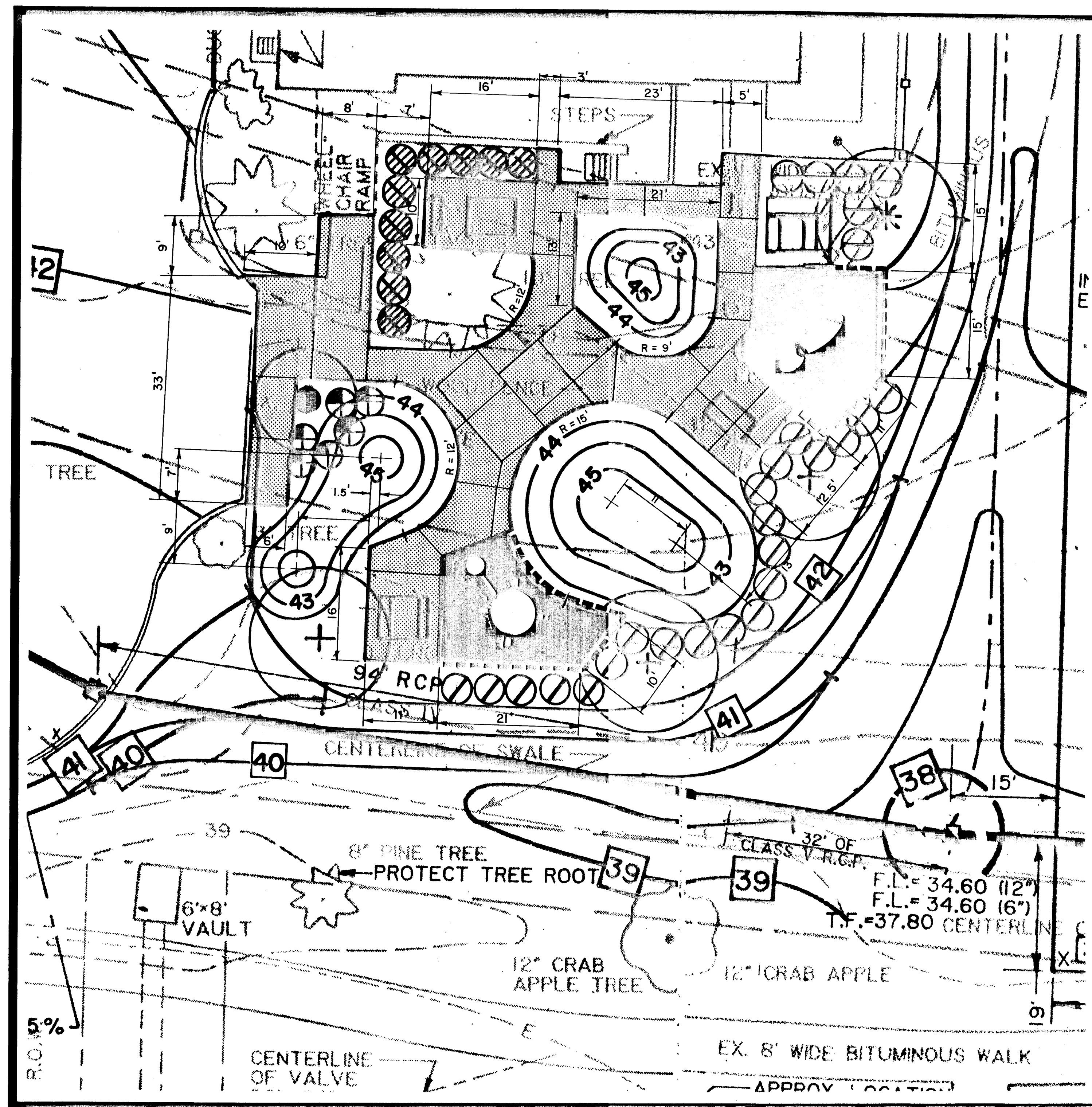

Table Detail



CLUB HOUSE



STANDARD FIELD LAYOUT

APPROVED: *Bernard E. Javorka* 2/10/92
CITY OF HARTFORD PARKS AND RECREATION DEPT. DATE

GENERAL NOTES

1. THE CONTRACTOR IS HEREBY REMINDED THAT TITLE 16 CHAPTER 293 OF THE CONNECTICUT GENERAL STATUTES REQUIRES NOTIFICATION TO UTILITY COMPANIES OF PENDING EXCAVATION AT OR NEAR PUBLIC UTILITIES. THE CONTRACTOR SHALL CALL 1-800-922-4455 AT LEAST 48 HOURS PRIOR TO EXCAVATION, BUT NOT MORE THAN 30 DAYS IN ADVANCE OF EXCAVATION.
2. ANY DAMAGE OF DISTURBANCE TO AREAS WITHIN OR OUTSIDE CONTRACT LIMITS WHICH RESULT FROM THE CONTRACTORS OPERATIONS SHALL BE PROMPTLY RESTORED TO THEIR ORIGINAL CONDITION.
3. EXERCISE EXTREME CAUTION WHEN EXCAVATING OR GRADING IN THE VICINITY OF TREES.
4. PROPOSED CONTOURS INDICATE INTENT. MINOR ADJUSTMENTS GRADING MAY BE MADE AS REQUIRED TO PROVIDE POSITIVE SURFACE DRAINAGE.
5. AN AREA 10' SQUARE IS TO BE SODDED AROUND ALL DRAIN INLETS IN LAWN AREAS AS SOON AS GRADING PERMITS.
6. BLEND NEW CONTOURS SMOOTHLY INTO EXISTING CONTOURS ROUND TOPS OR BOTTOMS.
7. PERFORM SEEDING OPERATIONS, OR SOD AS SOON AS GRADING IS COMPLETED TO REDUCE RUNOFF AND EROSION.
8. PLACE SILT FENCE AND HAY BALES WHERE INDICATED ON PLAN. MAKE ADJUSTMENTS TO LOCATIONS AS REQUIRED.
9. MAINTAIN HAY BALES AND SILT FENCING BY RESTAKING, RETIEFING, OR REMOVE SILT BUILD-UP AT HAY BALES OR SILT FENCE AS INSTRUCTED.
10. BENCHMARK ELEVATION 49.19 C.M.S., N.E. CORNER OF VICTORIA AND FRANKLIN AVENUE.
11. UPON COMPLETION OF ALL WORK CLEAN ALL EXIST. OR PROPOSED C.B. SUMPS OF DEBRIS, AND ALL DOWNSTREAM FLOWING IN PARK AREA IF REQUIRED.
12. CONSTRUCTION LAYOUT (LINE AND GRADE) WILL BE PROVIDED TO THE CONTRACTOR BY THE CITY OF HARTFORD DEPT. OF PUBLIC WORKS. THE CONTRACTOR MUST REQUEST CONSTRUCTION LAYOUT 48 HOURS IN ADVANCE.
13. THE LOCATIONS AND ELEVATIONS OF UNDERGROUND STRUCTURES OR PIPES HAVE BEEN OBTAINED FROM RECORDED DATA AND MAY DIFFER FROM ACTUAL FIELD CONDITIONS.
14. THE CONTRACTOR SHALL MAINTAIN ACCESS FOR OTHERS TO ALL BUILDINGS AT ALL TIMES.
15. WHERE PORTIONS OF EXISTING PAVEMENT ARE TO BE REMOVED, PAVEMENT SHALL BE NEATLY SAWCUT TO PROVIDE A STRAIGHT LINE. MATCH LINE AND GRADE OF NEW PAVEMENT WITH EXISTING PAVEMENT.
16. CONTRACTOR SHALL NOT ALLOW CATCH BASIN SUMPS TO FILL WITH SAND AND SOIL.
17. ALL DISTURBED AREAS NOT COVERED BY BUILDING, PAVING, PLANTING BEDS OR OTHER IMPROVEMENTS SHALL BE GRADED, TOPSOILED TO A SETTLED DEPTH OF 6" AND SEEDED OR SODDED.
18. EARTH BACKFILL MATERIAL SHALL BE PLACED IN THE TRENCH IN SUCH A MANNER THAT DISPLACEMENT OF THE CONDUIT WILL NOT OCCUR AND SO THAT THE FILTER AND BEDDING MATERIAL, AFTER BACKFILLING, WILL MEET THE REQUIREMENT OF THE PLANS AND SPECIFICATIONS.
19. ALL OPENINGS AT END OF UNDERDRAIN TO BE CAPPED AT TIME OF CONSTRUCTION.

Columbus Park
eqz 1/4

CITY OF HARTFORD, CONNECTICUT
DEPARTMENT OF PUBLIC WORKS
BUREAU OF ENGINEERING SERVICES

STANDARD FIELD LAYOUT
AND
MISCELLANEOUS DETAILS

SUBMITTED: *Harold J. O'Connell* RECOMMENDED: *Harold J. O'Connell* APPROVED: *Harold J. O'Connell*
PROJECT ENGINEER DIVISION MANAGER CITY ENGINEER

SHEET NO. 3 OF 6 DRAWN: G.S. SCALE 1" = 10.0' DAYBOOK NO. 010751
CHECKED: H.J.O. DATE: FEBRUARY, 1992