

96.38 B.M. ELEVATION ON C.M.S. AT NORTH-EAST
CORNER OF SOUTH ST. AND MAPLE AVE.

70.10 B.M. ELEVATION ON C.M.S. AT SOUTH-EAST
CORNER OF SOUTH ST. AND BECKET ST.

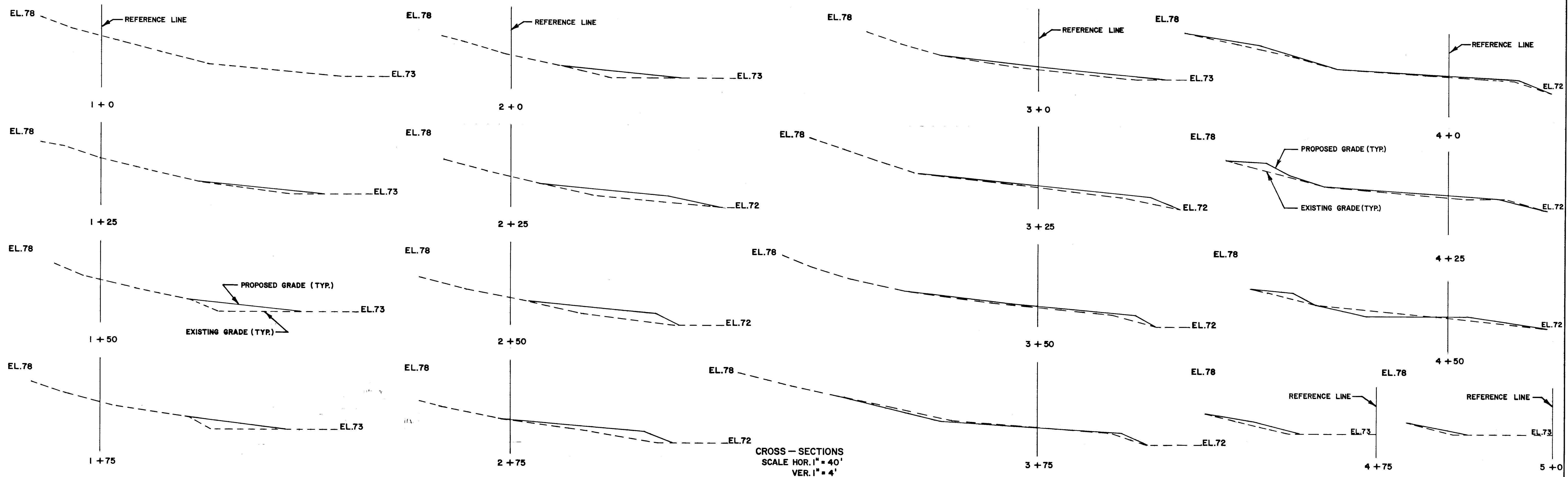

CROSS — SECTIONS
SCALE HOR. 1" = 40'
VER. 1" = 4'