

PLAN

SCALE: 1" = 200'

- Contractor's occupancy for work.
- Contractor's occupancy for storage of surplus excavation.

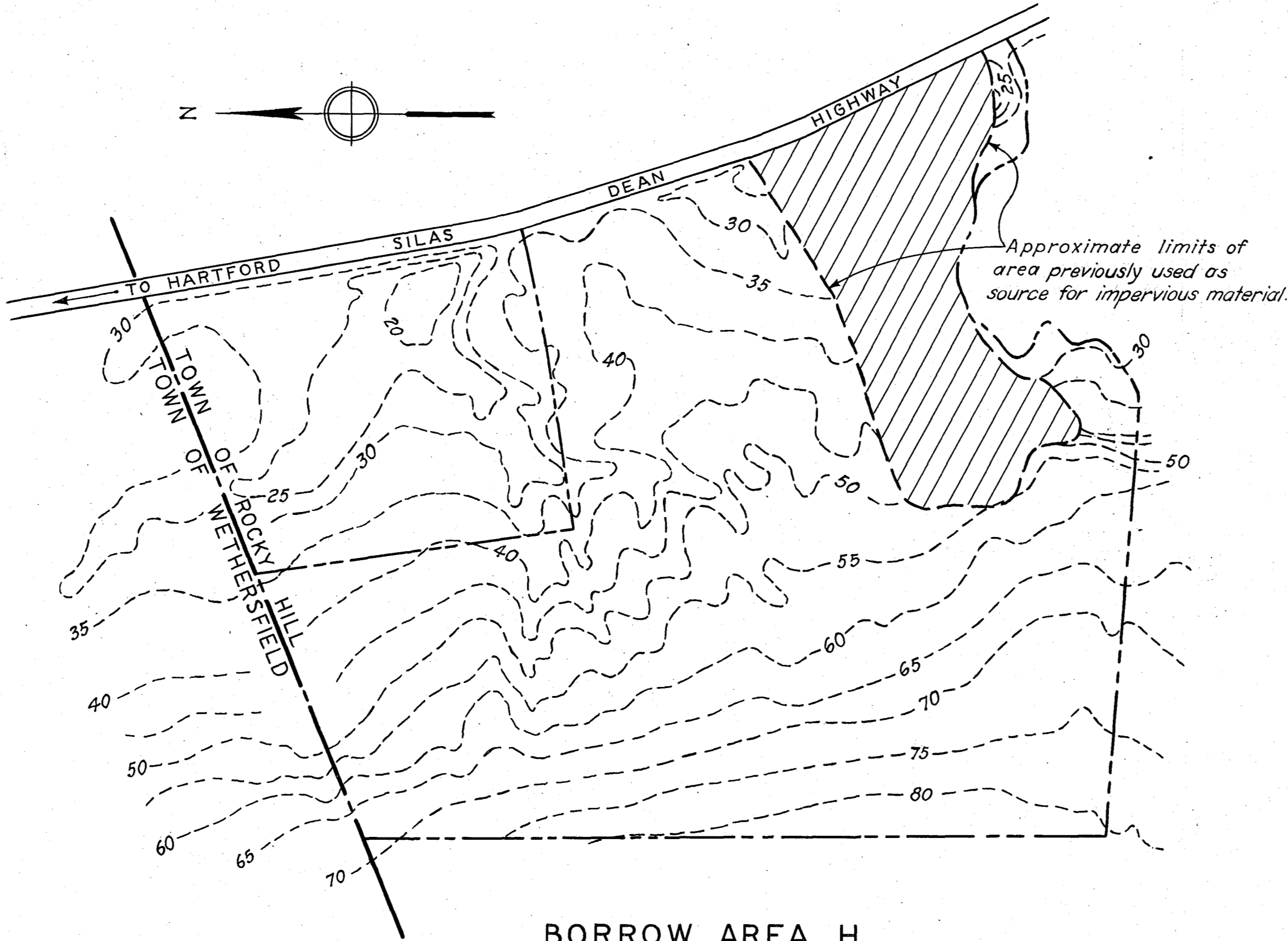

BORROW AREA H

SCALE: 1" = 200'

DESCRIPTION OF MATERIAL IN THE BORROW AREA

Formation, below 6" to 3 feet of topsoil, composed of 2 types: (1) medium to fine silt; and (2) mixed materials graded from gravel and coarse sand to fine silt. Materials available for impervious fill. Portion of area previously used for dike construction.

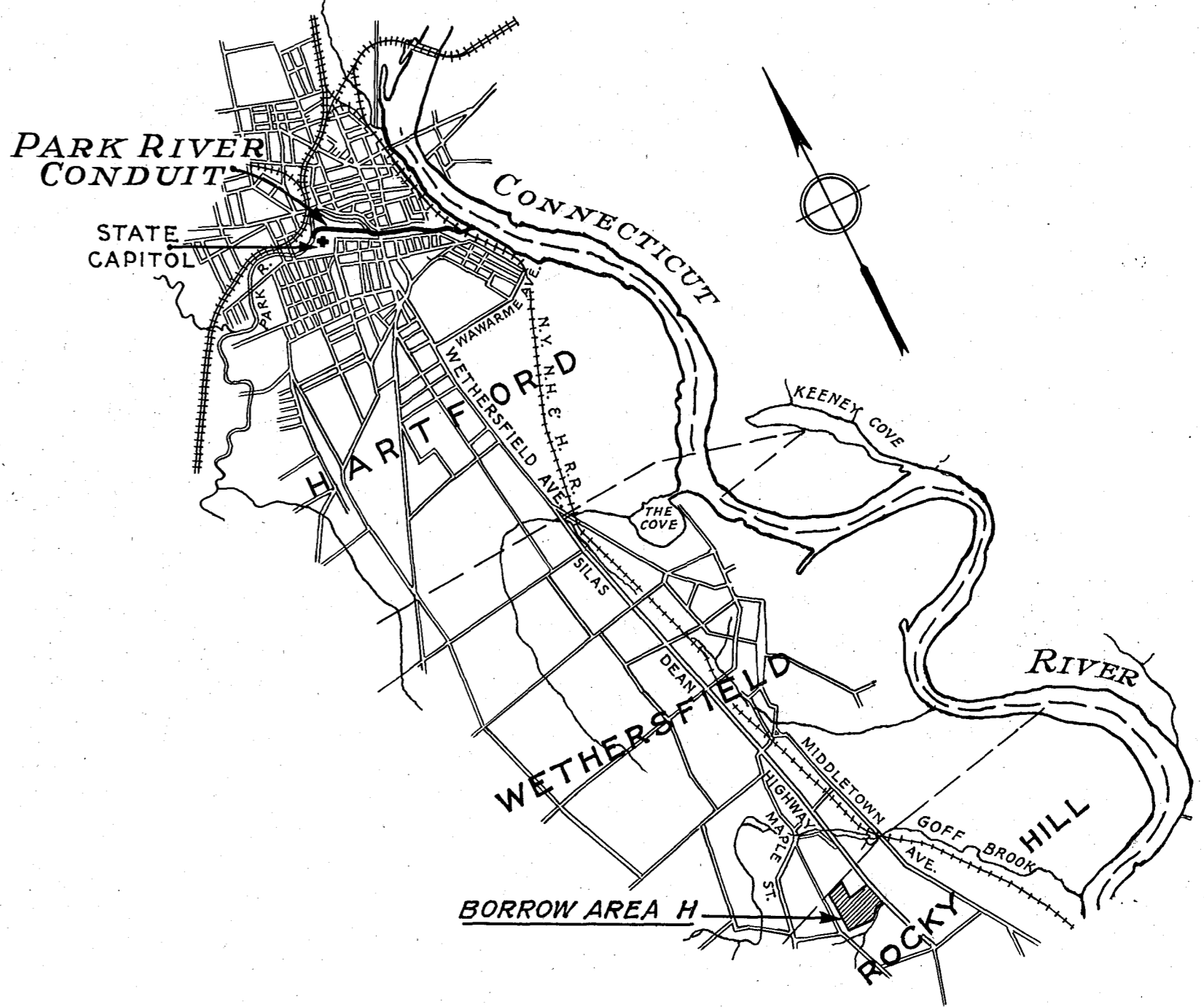

LOCATION MAP

SCALE: 1 IN. = 1 MI.
0 1 2

RECORD
DRAWINGS

METCALF & EDDY
ENGINEERS
BOSTON, MASS.

| KEY | DATE | REVISION (Indicated by Δ) | REV. BY | CK. BY | AR | BY |
|-----|----------|---------------------------|---------|--------|----|----|
| | 12-31-45 | As built. | | | | |

CONNECTICUT RIVER FLOOD CONTROL
PARK RIVER CONDUIT
HARTFORD, CONN.

CONTRACTORS WORK AREAS

CONNECTICUT RIVER CONNECTICUT
IN 48 SHEETS SCALE: 1 IN. = 200 FT. SHEET NO. 9
200' 0' 200' 400'

U.S. ENGINEER OFFICE PROVIDENCE, R.I. MAY 1940

REVIEWED: *H.W. Hamer* APPROVAL RECOMMENDED: *H.W. Hamer* APPROVED: *H.W. Hamer*
ENGINEER PRINCIPAL ENGINEER LT. COL. CORPS OF ENGINEERS
F.C. DESIGN SECTION CHIEF F.C. ENGINEERING DIV. DISTRICT ENGINEER
SUBMITTED: *Arthur L. Shaw* (PARTNER) DRAWN BY: H.C.T. FILE NO. CT-4-2607
METCALF & EDDY TRACED BY: H.C.T.
BOSTON, MASS. CHECKED BY: P.W.T.