

MAP REFERENCE:

- 1.) MAP ENTITLED, "PROPERTY MAP COUNTRY INNS OF NEW ENGLAND INC. PROPERTY OF THOMAS K. STANDISH WESTON STREET (AT NEW JENNINGS ROAD) HARTFORD, CONNECTICUT DATE 6-87 SCALE: 1"=40' MESSIER & ASSOCIATES ENGINEERS AND LAND SURVEYORS."
- 2.) MAP ENTITLED, "PLAN SHOWING TRACK E-2-4 ON WESTON STREET IN HARTFORD, CONNECTICUT SCALE: 1"=100' DATE: 10-18-83 FRANCIS T. D'ONOFRIO L.S."
- 3.) "STATE OF CONNECTICUT DEPARTMENT OF TRANSPORTATION RIGHT OF WAY MAP TOWN OF HARTFORD INTERSTATE ROUTE 91 FROM INTERSTATE ROUTE 84 NORTHERLY TO THE WINDSOR TOWN LINE SCALE 1"=80' NOV. 8, 1995 NUMBER 63-13 SHEETS 3 & 4 OF 7 JOHN R. PUGLISI L.S."
- 4.) MAP ENTITLED, "SITE DEVELOPMENT PLAN PREPARED FOR: JOHN ORSINI WEST SERVICE ROAD CONNECTOR HARTFORD, CONNECTICUT DATE: 11/06 REVISED THRU 02-16-07 SCALE: 1"=40' SHEET 2 OF 6 ROBERT R. MESSIER L.S."

n/f JOHN L. ORSINI

AREA=  
66,110.822 S.F.  
1.518 Ac.

WEST SERVICE ROAD

WEST SERVICE ROAD CONNECTOR

N/F STATE OF CONNECTICUT (INTERSTATE #91 SOUTHBOUND ENTRANCE RAMP)

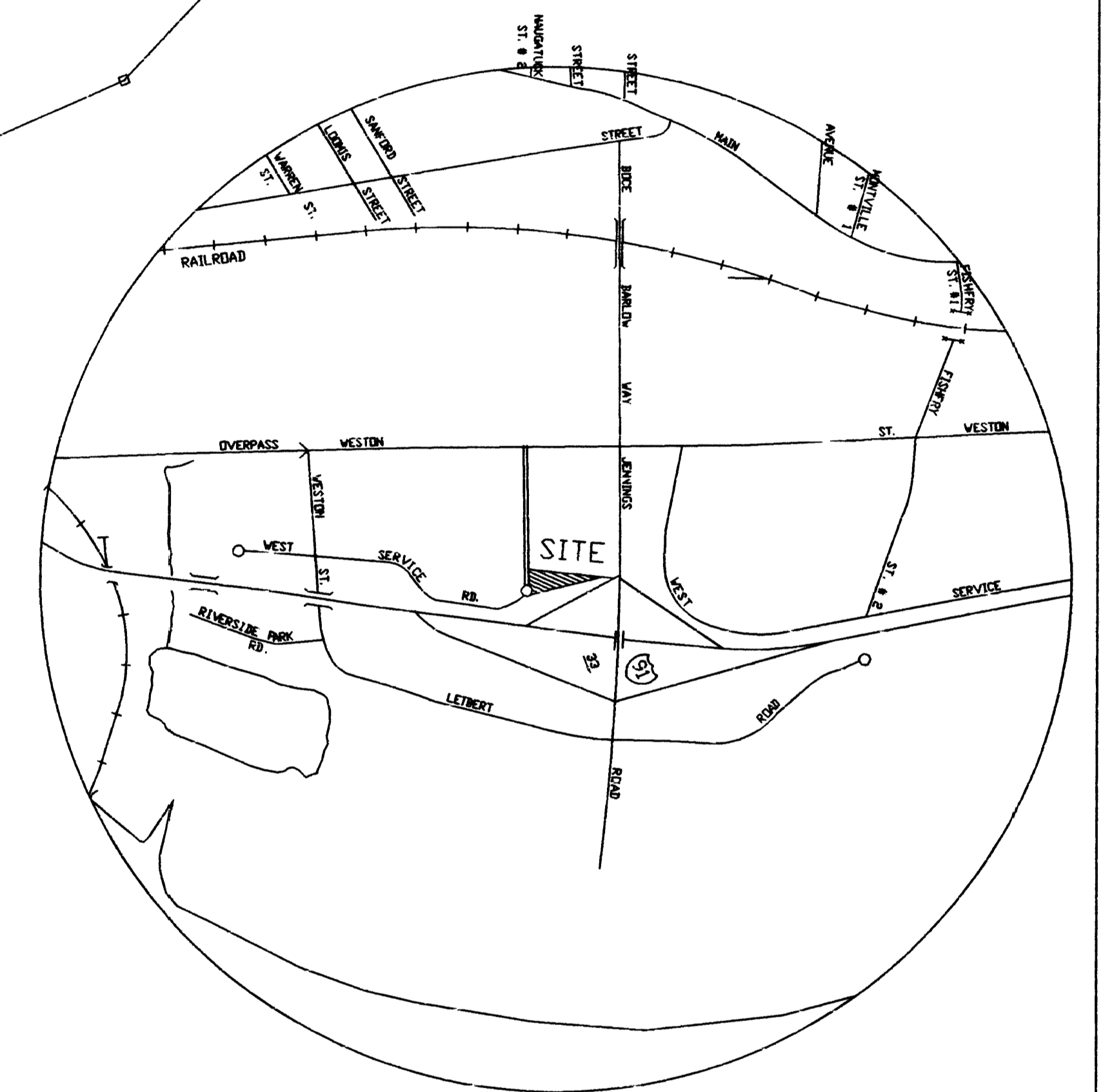

KEY MAP (N.T.S.)

CERTIFICATION:

- 1.) THIS MAP AND SURVEY WERE PREPARED IN ACCORDANCE WITH THE REGULATIONS OF CONNECTICUT STATE AGENCIES, SECTIONS 20-300B-1 THRU 20-300B-30, AND THE RECOMMENDED STANDARDS FOR SURVEYS AND MAPS IN THE STATE OF CONNECTICUT EFFECTIVE SEPTEMBER 26, 1996 PREPARED AND ADOPTED BY THE CONNECTICUT ASSOCIATION OF LAND SURVEYORS, INC. PURSUANT TO AND AS SET FORTH THESE STANDARDS.
- 2.) THIS MAP AND SURVEY WERE PREPARED FOR HARTFORD ECONOMIC DEVELOPMENT COMMISSION TO BE USED IN MATTERS THAT RELATE TO A PROPERTY DEEDING. USE OF THIS MAP FOR OTHER PURPOSES OR BY OTHER PARTIES IS BOTH NOT AUTHORIZED OR VALID.
- 3.) NO DECLARATION IS EXPRESSED OR IMPLIED BY THIS MAP OR COPIES THEREOF UNLESS IT BEARS THE IMPRESSION TYPE SEAL AND ORIGINAL LIVE SEAL AND ORIGINAL LIVE SIGNATURE OF THE SURVEYOR WHOSE NAME AND REGISTRATION NUMBER APPEAR BELOW. ANY CHANGES MADE TO THIS PLAN WITHOUT THE KNOWLEDGE OF THE SIGNERS INVALIDATES THESE DECLARATIONS.

TO THE BEST OF MY KNOWLEDGE AND BELIEF THIS MAP IS SUBSTANTIALLY CORRECT AS NOTED HEREON.

PETER D. FLYNN CT.L.S. #6792 DATE 5-22-07  
NOT VALID UNLESS ORIGINAL SIGNATURE, LIVE STAMP, & RAISED SEAL ARE AFFIXED.

FLYNN & CYR LAND SURVEYING LLC  
370 BERLIN TURNPIKE 060-282-7888  
BERLIN, CONNECTICUT 06037

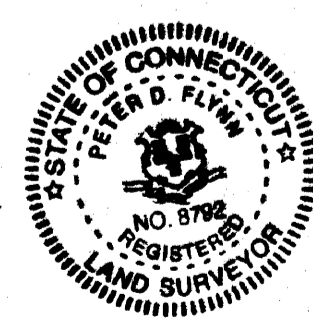

INDICATED UNDERGROUND UTILITIES ARE BASED ON AVAILABLE DATA. THE LOCATIONS ARE APPROXIMATE AND ALL UTILITIES MAY NOT BE SHOWN. PRIOR TO CONSTRUCTION, CONTRACTOR SHALL CALL 1-800-922-4455 AND HAVE ALL UTILITIES MARKED.

THIS DRAWING HAS BEEN PREPARED BASED, IN PART, ON INFORMATION PROVIDED BY OTHERS RELATING TO THE LOCATION OF UNDERGROUND SERVICES. WE CANNOT VERIFY THE ACCURACY OF THIS INFORMATION AND SHALL NOT BE HELD RESPONSIBLE FOR ANY ERRORS OR OMISSIONS, WHICH MAY BE INCORPORATED HEREIN AS A RESULT.

Flynn Land Surveying  
Original Ink  
Drawing on Mylar

LEGAL DESCRIPTIONS:

A. EXISTING 91 WEST SERVICE ROAD BOUNDARY

BEGINNING AT A POINT ALONG THE WESTERLY HIGHWAY LINE OF THE INTERSTATE 91 SOUTHBOUND ENTRANCE RAMP, SAID POINT BEING ABOUT 45.0 FEET FROM THE SOUTH STREET LINE OF JENNINGS ROAD, SAID POINT ALSO BEING THE NORTH-EAST CORNER OF PROPERTY OWNED NOW OR FORMERLY BY JOHN L. ORSINI AND THE NORTHWEST CORNER OF PROPERTY HEREIN DESCRIBED, BEING MORE PARTICULARLY BOUNDED AND DESCRIBED AS FOLLOWS:

THENCE: S25°02'17"E A DISTANCE OF 148.33 FEET TO A POINT;  
THENCE: S02°10'02"E A DISTANCE OF 90.01 FEET TO A POINT;  
THENCE: S01°04'33"E A DISTANCE OF 306.84 FEET TO A POINT;  
THENCE: N19°21'33"W A DISTANCE OF 17.90 FEET TO A POINT;  
THENCE: ON A CURVE TO THE LEFT WITH A DELTA 133°02'00", A RADIUS OF 60.0 FEET AND AN ARC LENGTH OF 139.31 FEET TO A POINT;  
THENCE: N67°46'21"W A DISTANCE OF 145.91 FEET TO A POINT;  
THENCE: N22°13'39"E A DISTANCE OF 442.36 FEET TO THE POINT AND PLACE OF BEGINNING.

SAID PARCEL OF LAND CONTAINS 66,110.822 Square Feet or 1.518 Acres.

BOUNDARY SURVEY  
SHOWING LAND TO BE DEEDED TO  
THE HARTFORD ECONOMIC  
DEVELOPMENT COMMISSION  
BY THE CITY OF HARTFORD  
#91 WEST SERVICE ROAD  
HARTFORD, CONNECTICUT  
SCALE 1"=20' MAY 21, 2007

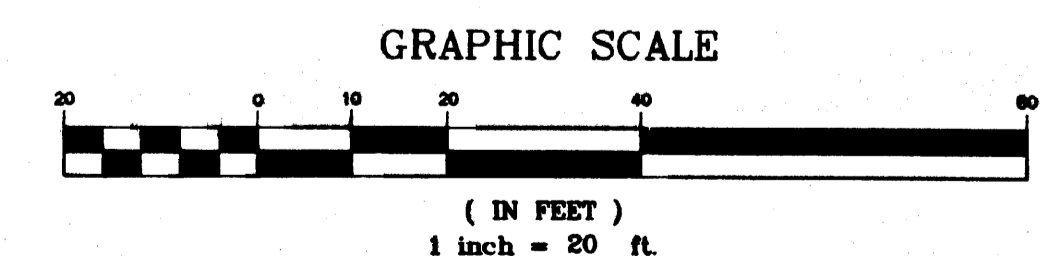

2011 MAY 22 P. 2-30