

RECEIVED BY
81-01-A P.1 RSN 1005
2003-09-02

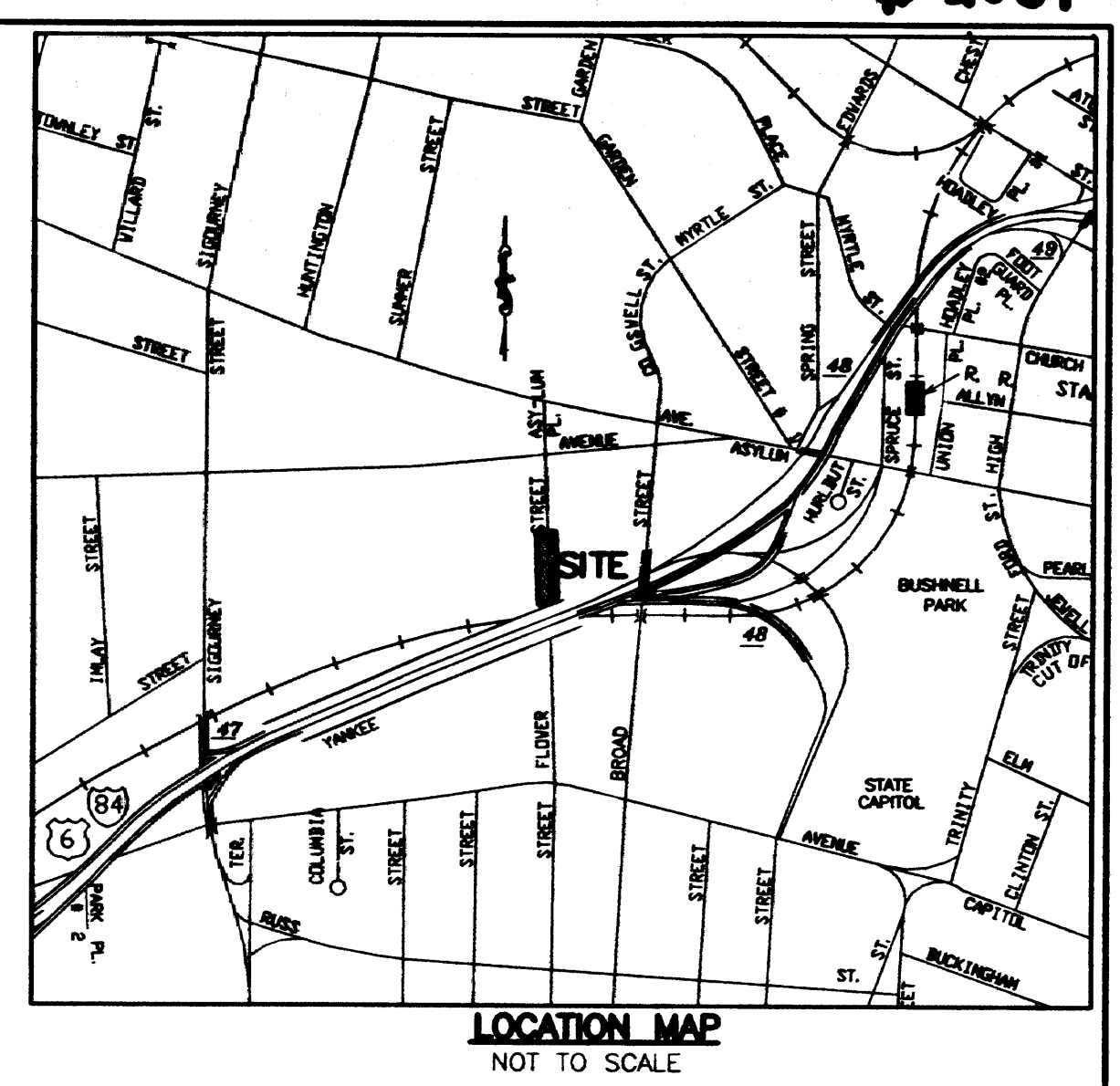
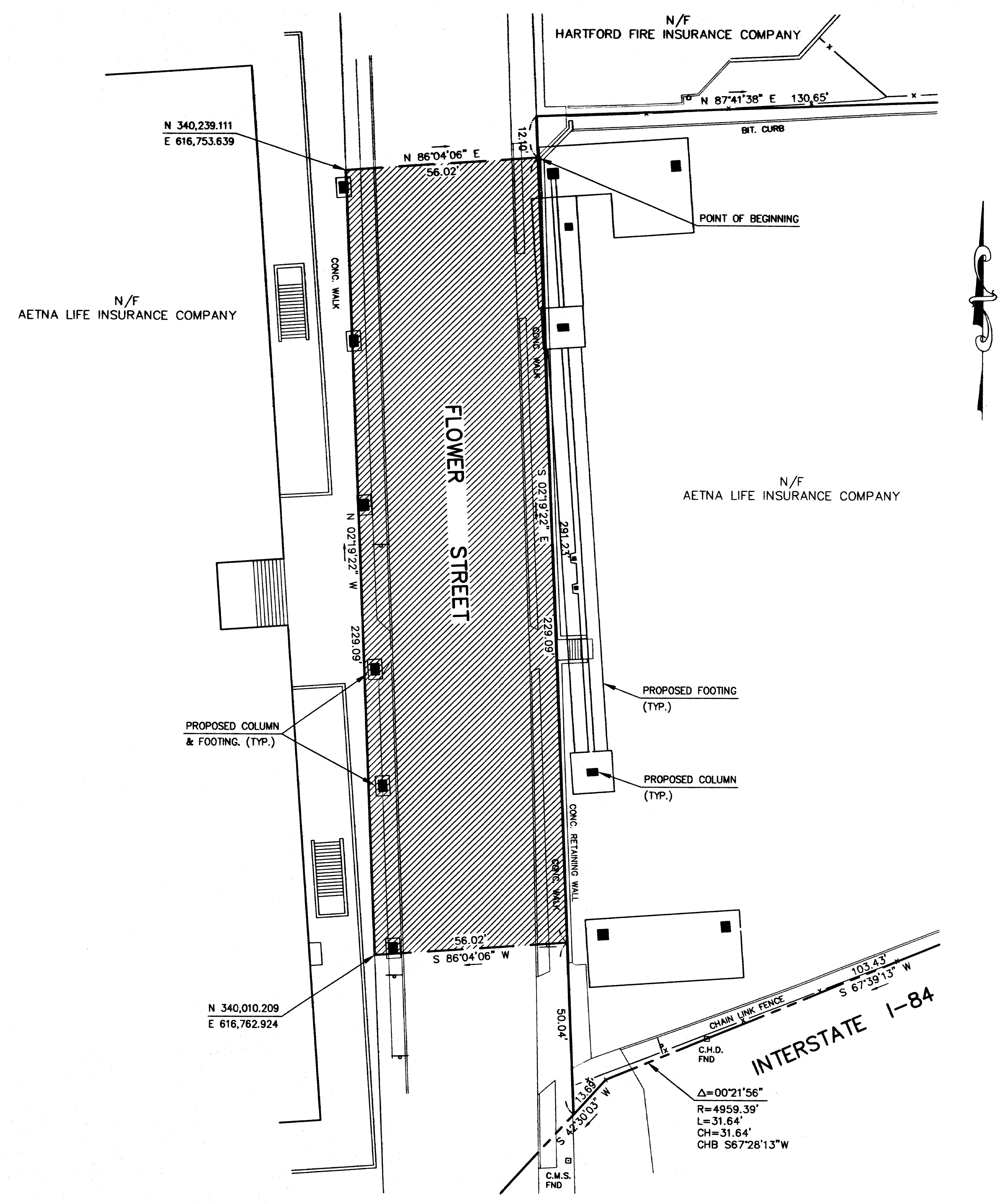

NOTES:

1. THIS SURVEY AND MAP HAS BEEN PREPARED IN ACCORDANCE WITH SECTIONS 20-3008-1 THRU 20-3008-20 OF THE REGULATIONS OF CONNECTICUT STATE AGENCIES - "STANDARDS FOR SURVEYS AND MAPS IN THE STATE OF CONNECTICUT" AS ADOPTED BY THE CONNECTICUT ASSOCIATION OF LAND SURVEYORS, INC. ON SEPT. 26, 1996.
2. THIS IS AN EASEMENT MAP AND IT IS A TYPE OF A SURVEY INTENDED TO DEPICT THE POSITION OF A PROPOSED EASEMENT WITH RESPECT TO BOUNDARY MONUMENTATION; IMPROVEMENTS AND FEATURES; OTHER RECORD EASEMENTS AND VISIBLE EVIDENCE OF THE USE THEREOF; AND UNRESOLVED CONFLICTS WITH RECORD DEED DESCRIPTIONS AND MAPS.
3. PROPERTY LINE DETERMINATION IS BASED UPON A DEPENDENT RESURVEY AND EASEMENT BOUNDARY DETERMINATION IS BASED UPON AN ORIGINAL SURVEY.
3. THIS SURVEY CONFORMS TO CLASS A-2 HORIZONTAL ACCURACY.
4. COORDINATES ARE BASED ON CGS 1927.
5. THIS SURVEY IS NOT VALID WITHOUT A LIVE SIGNATURE AND EMBOSSED SEAL.

MAP REFERENCES:
1. "PROPERTY SURVEY, PROPERTY OF THE YOUNG WOMEN'S CHRISTIAN ASSOCIATION OF THE HARTFORD REGION, INC., 135 BROAD STREET & FARMINGTON AVENUE, HARTFORD, CONNECTICUT, SCALE: 1 INCH = 20 FEET, DATE: SEP. 2, 2003" BY REESE ROBERTS, L.S.
2. "PLAN PREPARED FOR HARTFORD ACCIDENT AND INDEMNITY COMPANY, FLOWER STREET & FARMINGTON AVENUE, HARTFORD, CONN., SCALE: 1"= 20', DATE 2-2-88" BY MEEHAN ASSOCIATES.
3. "PROPOSED EXCHANGE BETWEEN HARTFORD INSURANCE GROUP AND AETNA LIFE AND CASUALTY COMPANY, FLOWER STREET, HARTFORD, CONNECTICUT, SCALE 1"= 20', DATE JULY 1981" BY CLOSE, JENSEN & MILLER.

TO MY KNOWLEDGE AND BELIEF THIS MAP IS SUBSTANTIALLY CORRECT AS NOTED HEREON.
By *John H. Miller*
JOHN H. MILLER, P.E., L.S.
LIC. NO. 4142

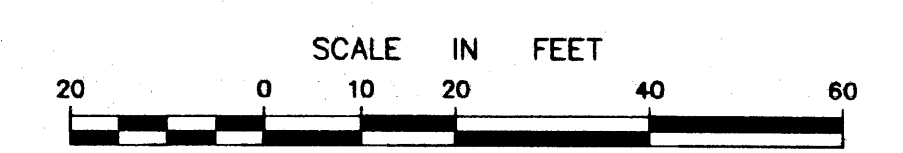

THIS MAP PRODUCED BY ORIGINAL INK DRAWING ON POLY FILM OR LITHO. CLOSE, JENSEN AND MILLER, P.C. 1332 SILAS DEANE HIGHWAY WETHERSFIELD, CT 06109

No. Date Description Revisions	3 2/08/07 DESCRIPTION REMOVED	C. J. M. Close, Jensen & Miller, P.C. Consulting Engineers, Land Planners & Surveyors 1137 Silas Deane Highway, Wethersfield, Conn. 06109, Tel. (860)563-9375	Compiled ETJ
	2 2/07/07 COORDINATES, FOOTINGS & COLUMNS ADDED		P.C. Check
	1 08/01/06 ADDED EASEMENT AGREEMENT		Designed
No. Date Description Revisions		EASEMENT MAP PROPOSED AIR RIGHTS ACROSS THE PROPERTY OF CITY OF HARTFORD TO BE GRANTED TO AETNA LIFE INSURANCE COMPANY FLOWER STREET HARTFORD, CONNECTICUT	Drawn ETJ
			Checked
			Scale 1"= 20'
			Date 4/05/06
			Sheet 1 of 1
			Job No.
			File No.