

1. PRIOR TO ANY CONSTRUCTION OPERATIONS, THE CONTRACTOR SHALL ESTABLISH ADEQUATE GRADING INFORMATION FOR PROPOSED WORK TO ALLOW FOR THE EVALUATION OF ITS RELATIONSHIP TO EXISTING SITE FEATURES AND VEGETATION. THE CONTRACTOR SHALL NOTIFY THE OWNER'S REPRESENTATIVE IF ANY SURVEY INFORMATION IS INCORRECT. IF REQUIRED, FIELD MODIFICATIONS AS AUTHORIZED BY THE OWNER'S REPRESENTATIVE SHALL BE MADE TO SAVE EXISTING SITE FEATURES OR VEGETATION.
2. SITE LAYOUT & PROPOSED GRADES ARE TO BE STAKED IN THE FIELD AND APPROVED BY THE OWNER'S REPRESENTATIVE PRIOR TO THE BEGINNING OF CONSTRUCTION OPERATIONS.
3. THE CONTRACTOR IS RESPONSIBLE FOR ANY DAMAGE INSIDE AND OUTSIDE THE CONTRACT LIMIT LINE DUE TO CONSTRUCTION OPERATIONS.
4. THE CONTRACTOR IS RESPONSIBLE FOR LOCATING ALL UTILITIES IN THE FIELD BEFORE BEGINNING ANY EXCAVATION. CALL 48 HOURS IN ADVANCE FROM ANYWHERE IN THE STATE OF CONNECTICUT, "CALL BEFORE YOU DIG": 1-800-422-4455.
5. THE CONTRACTOR SHALL MAINTAIN ACCESS TO FIRE HYDRANTS AT ALL TIMES.
6. THE CONTRACTOR SHALL COMPLY WITH ALL STATE, LOCAL AND FEDERAL REGULATIONS.
7. THE CONTRACTOR SHALL MAINTAIN ACCESS FOR OTHERS TO ALL BUILDINGS AT ALL TIMES.
8. PLACE EROSION CONTROLS AS REQUIRED. MAKE ADJUSTMENTS TO LOCATIONS AS REQUIRED BY FIELD CONDITIONS AND AS AUTHORIZED BY THE OWNER'S REPRESENTATIVE OR BY LOCAL AUTHORITIES.
9. MAINTAIN EROSION CONTROLS BY RESTAKING, RETYING, ADJUSTING OR REPLACEMENT AS REQUIRED AND AS DIRECTED BY THE OWNER'S REPRESENTATIVE. REMOVE EXCESSIVE BUILDUP OF SILT.
10. DO NOT ALLOW CATCH BASIN SUMPS TO FILL WITH SAND AND SOIL.
11. AS CONSTRUCTION PROCEEDS, FINE GRADE AND MULCH AS SOON AS POSSIBLE TO REDUCE RUNOFF.
12. PROPOSED GRADES INDICATE INTENT. THE CONTRACTOR SHALL VERIFY ELEVATIONS AND MAKE ADJUSTMENTS AS REQUIRED AND AUTHORIZED BY THE OWNER'S REPRESENTATIVE, TO MEET FIELD CONDITIONS AND TO PROVIDE POSITIVE SURFACE DRAINAGE.
13. ALL NEW PAVEMENTS SHALL BE PITCHED SO AS TO PROVIDE COMPLETE AND POSITIVE DRAINAGE. ADJUST EXISTING DRAINAGE STRUCTURES TOP ELEVATIONS AS REQUIRED.
14. BLEND NEW GRADES SMOOTHLY WITH EXISTING, ROUND TOPS AND BOTTOMS OF SLOPES.
15. FINISH TOP ELEVATIONS SHOWN FOR LAWN DRAINS, CATCH BASINS, ETC. SHALL BE SET AS REQUIRED IN ORDER THAT ALL SURFACE DRAINAGE IS INTERCEPTED IN CONFORMANCE WITH THE INTENT OF THE GRADING PLAN.
16. CLEAN OUT EXISTING CB TO BE CONVERTED TO A MANHOLE AND PROPOSED CBS AT THE COMPLETION OF THE JOB.
17. TREE PROTECTION AND FENCING SHALL BE INSTALLED AND MAINTAINED IN PLACE DURING CONSTRUCTION OPERATIONS. IT SHALL BE REMOVED ONLY WHEN CONSTRUCTION OPERATIONS ARE COMPLETE. WOODED AREAS WHERE CONSTRUCTION DOES NOT OCCUR SHALL REMAIN UNDISTURBED.
18. ALL DISTURBED AREA NOT COVERED BY BUILDING, PAVING, PLANTING BEDS OR OTHER IMPROVEMENTS AND NOT DESIGNATED ROCK SLOPE OR LEDGE, SHALL BE GRADED, TOPSOILED TO A DEPTH OF 6" AND MULCHED.

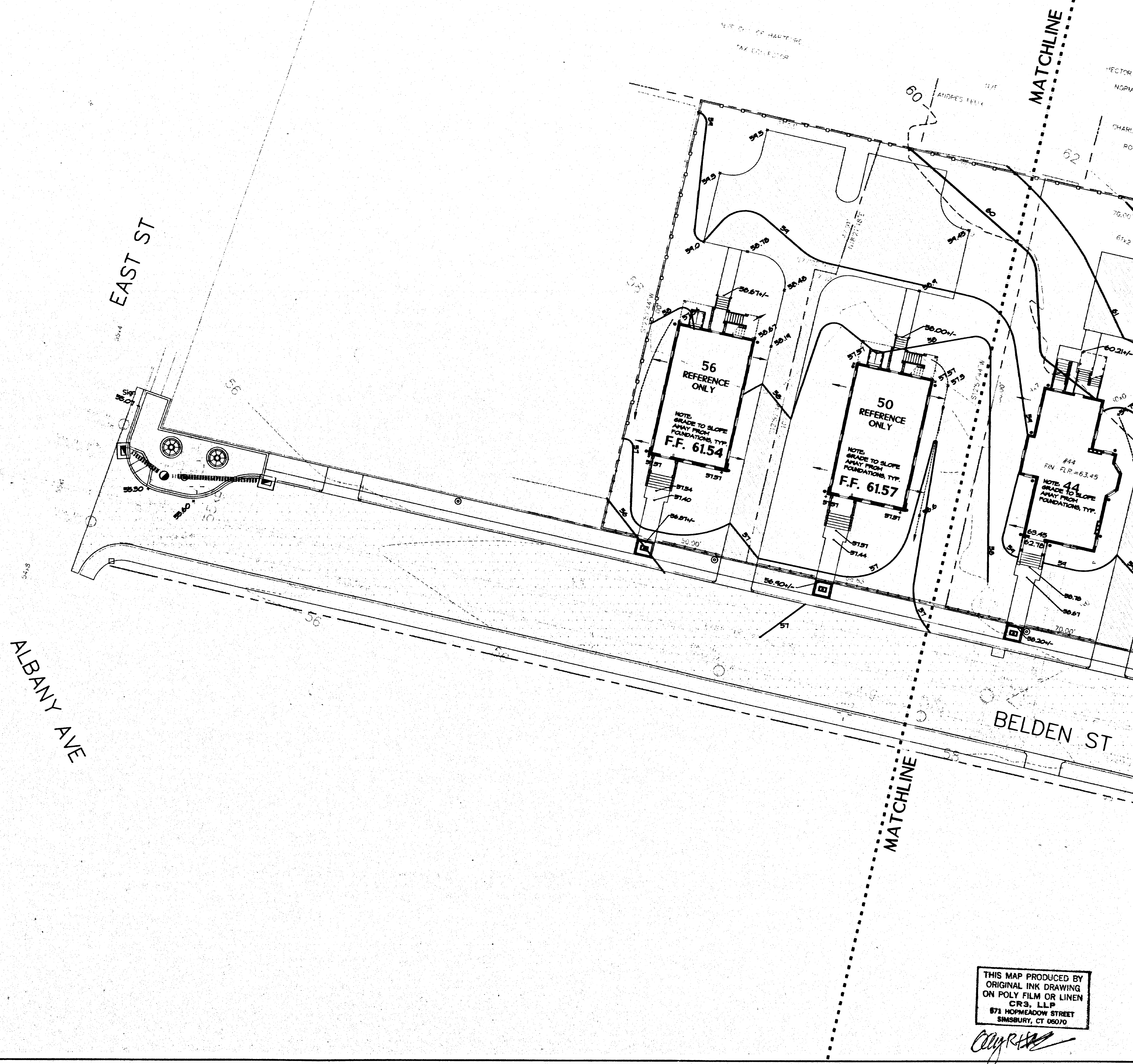

THIS MAP PRODUCED BY
ORIGINAL INK DRAWING
ON POLY FILM OR LINEN
CR3, LLP
571 HOPMEADOW STREET
SMBURY, CT 06070

Coly R ~~HA~~

REVISIONS

DRAWN BY: _____
CHECKED BY: _____

CLARK ENGINEERING
CIVIL ENGINEERING
P.O. Box 419, Granby, CT 06035-0419
CT (860) 853-4352 MA (413) 534-0711
FAX (860) 853-0415

B.J.F.W.
BARSHART • JOHNSON • FRANCIS and WILD
CONSULTING ENGINEERS
21 GREEN GLEN AVE. GLENVIEW, ILL. 60045

SITE AND STREETSCAPE IMPROVEMENTS
BELDEN STREET
HARTFORD, CONNECTICUT

RECEIVED BY
D. A. [Signature]
TOWN & CITY CLERK
2006 AUG 22 P 2:22

NOTES

This drawing & details on it as an instrument of service, is the property of OR3 LLP. It is to be used for this specific project and shall not be loaned, copied, or reproduced without consent of OR3 LLP.

SHEET NO.
L2A.2

TITLE
**SITE
GRADING**

SCALE	1"=20'-0"
DATE	03/25/2004
PROJ. NO.	2003 070

#2841-2