

#2735

273

1

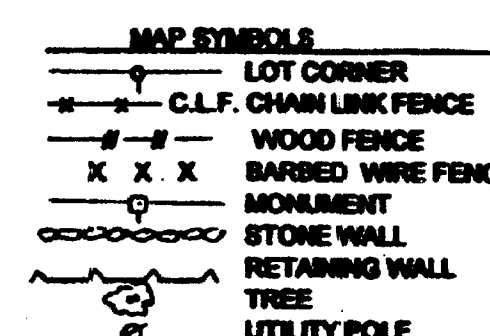

RICHARD T. TOURVILLE PLS No. 8177
24 WINDING LANE, AVON, CT. 06001

UTILITIES
PREMISES ARE SERVED FOR WATER, SEWER,
ELECTRIC AND GAS FROM PUBLIC R.O.W.

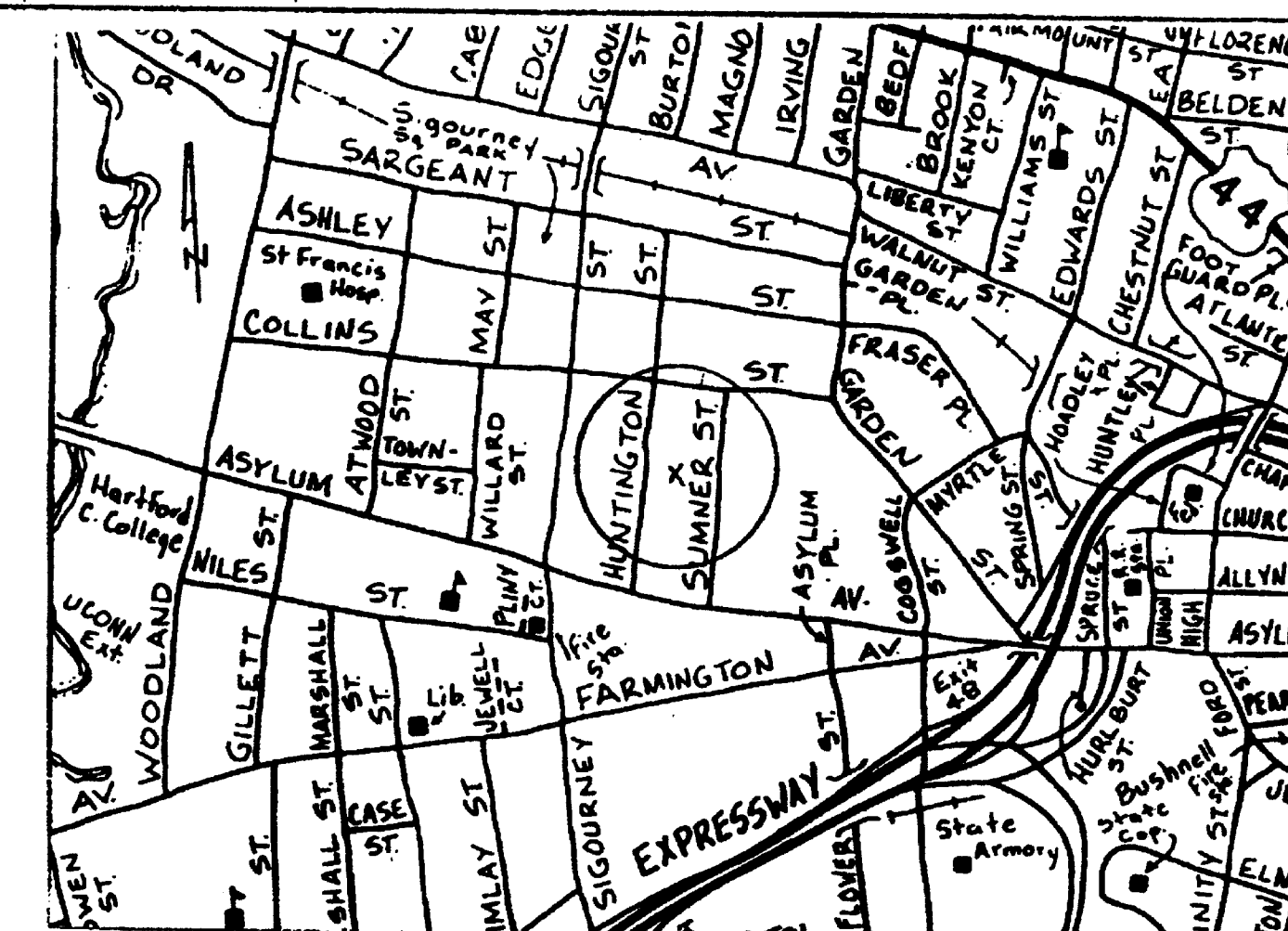

1. This map or plat and the survey on which it is based are made in accordance with the "Minimum Standard Land Requirements for ALTA/ACSM Land Title Surveys", jointly established and adopted by the American Land Title Association and the American Congress on Surveying and Mapping. This map and survey meet the requirements for an urban survey as defined there.
2. The survey was made on the ground between 12/04/04 and 12/18/04 and correctly shows the area of the subject property, the location and type of all structures, and other improvements situated as the subject property, and any other matter that is material to the subject property.
3. Except as shown on the survey, there are no visible encumbrances or rights of way of which the underigned has been advised.
4. Except as shown on the survey, there are no other observable, above ground encumbrances (a) by or in favor of the subject property upon adjoining properties, streets or alleys, or (b) by the subject property upon adjoining properties, street or alleys upon the subject property.
5. The location of each easement, right of way, servitude and other matter affecting the subject property is shown on the survey in the life insurance commitment dated 11-14-04.
6. Except as shown on the survey, there are no other encumbrances. Title Insurance Company of the subject to the subject property, has been advised on the survey, together with appropriate recording references, to the effect that such matters can be located. The property shown on the survey is the property of the subject property and is free of all improvements on the subject property is in accord with minimum standard provisions and restrictions of records referenced in each title commitment.
7. The subject property has access to and from a duly dedicated and accepted public street or highway.
8. Except as shown on the survey, the subject property does not serve any adjoining property for drainage, utilities, or ingress egress.
9. The correct description of the subject property forms a mathematically closed figure.
10. Except as shown on the survey, no portion of the property shown on the survey lie within a Special Hazard Area as described on the Flood Insurance Rate Map for the community in which the subject property is located.

**PLAN SHOWING PROPERTY AT
65 SUMNER STREET
TO BE ACQUIRED BY
COOLIDGE WOODLAND LLC
SCALE 1" = 30' DATE 12-11-04**

ORIGINAL INK ON
POLYESTER FILM

