

MAP REFERENCE:

MAP ENTITLED, "SUBDIVISION PLAN REDEVELOPMENT OF HARRIET BEECHER STOWE VILLAGE FOR THE HOUSING AUTHORITY OF THE CITY OF HARTFORD, CONNECTICUT CM DEVELOPMENT TEAM, LLC SCALE: 1"=40' DATE: 7-9-99 SHEETS C-1 THRU C-5 PETER D. FLYNN L.S.

N/F CITY OF HARTFORD  
BOARD OF EDUCATION  
"FRED D. WISH JR. SCHOOL"

N/F HOUSING AUTHORITY OF THE CITY OF HARTFORD - LOT #38  
LOT #38-A

REGULATIONS FOR R-4 ZONE

ITEM	REQUIRED
MIN. LOT AREA	6,000 S.F.
MIN. FRONTAGE	50'
MIN. FRONT YARD	25'
MIN. SIDE YARD	7.5'
AGG. SIDE YARD	15'
MIN. REAR YARD	30'

INDICATED UNDERGROUND UTILITIES ARE BASED ON AVAILABLE DATA. THE LOCATIONS ARE APPROXIMATE AND ALL UTILITIES MAY NOT BE SHOWN PRIOR TO CONSTRUCTION. CONTRACTOR SHALL CALL 1-800-922-4455 AND HAVE ALL UTILITIES MARKED.

THIS DRAWING HAS BEEN PREPARED BASED, IN PART, ON INFORMATION PROVIDED BY OTHERS RELATING TO THE LOCATION OF UNDERGROUND SERVICES. WE CANNOT VERIFY THE ACCURACY OF THIS INFORMATION AND SHALL NOT BE HELD RESPONSIBLE FOR ANY ERRORS OR OMISSIONS, WHICH MAY BE INCORPORATED HEREIN AS A RESULT.

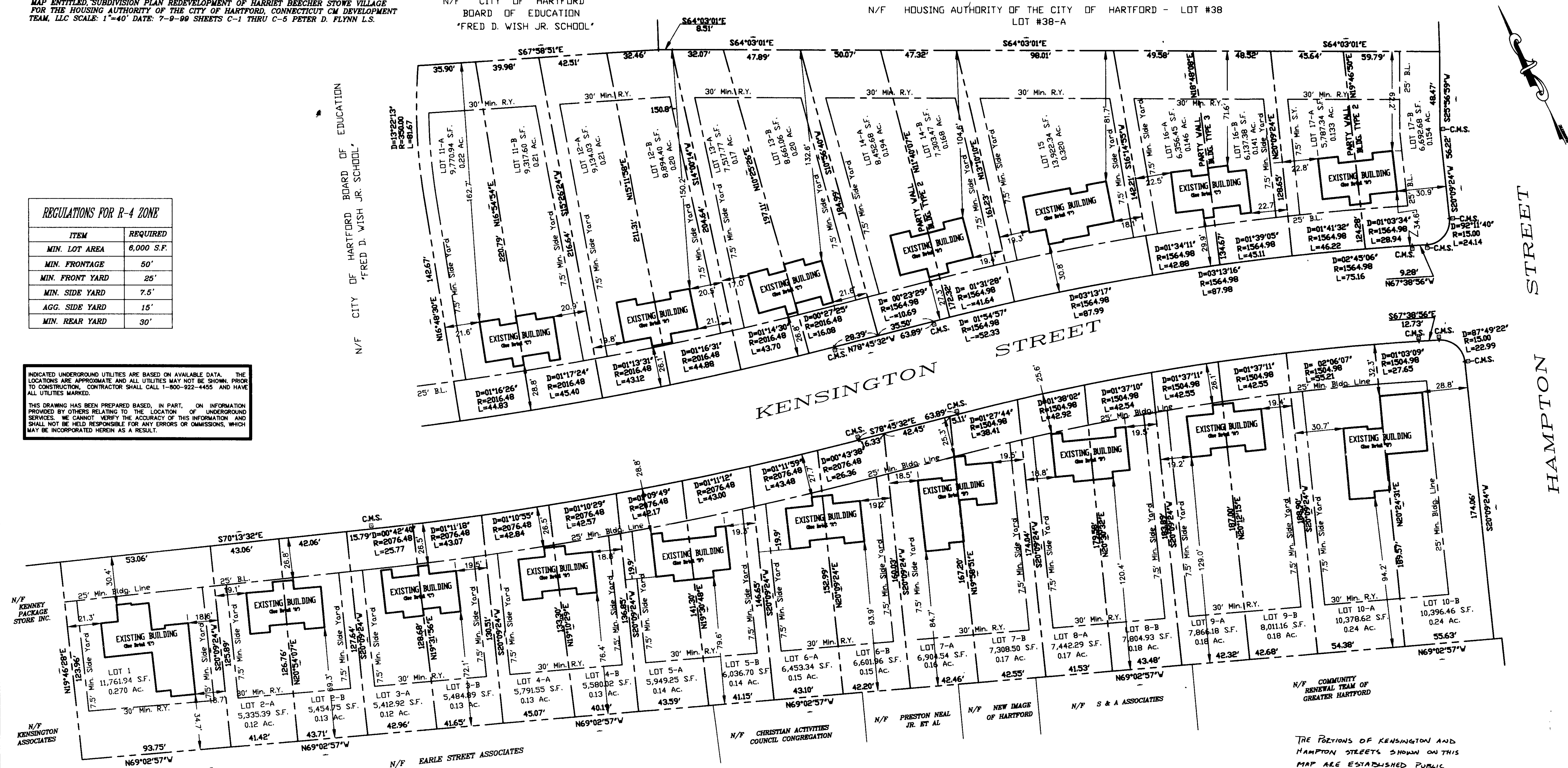

CERTIFICATION:

1. THIS MAP AND SURVEY WERE PREPARED IN ACCORDANCE WITH THE REGULATIONS OF CONNECTICUT STATE AGENCIES, SECTIONS 20-300B-1 THRU 20-300B-50, AND THE RECOMMENDED STANDARDS FOR SURVEYS AND MAPS IN THE STATE OF CONNECTICUT EFFECTIVE SEPTEMBER 26, 1996 PREPARED AND ADOPTED BY THE CONNECTICUT ASSOCIATION OF LAND SURVEYORS, INC. PURSUANT TO AND AS SET FORTH THEREIN.
  2. THIS MAP AND SURVEY WERE PREPARED FOR CM DEVELOPMENT TEAM, LLC. TO BE USED IN MATTERS THAT RELATE TO AS-BUILT CONDITIONS. USE OF THIS MAP FOR OTHER PURPOSES OR BY OTHER PARTIES IS NOT AUTHORIZED OR VALID.
  3. NO DECLARATION IS EXPRESSED OR IMPLIED BY THIS MAP OR COPIES THEREOF UNLESS IT BEARS THE IMPRESSION THIS SEAL AND ORIGINAL LIVE SEAL AND ORIGINAL LIVE SIGNATURE OF THE SURVEYOR WHOSE NAME AND REGISTRATION NUMBER APPEAR BELOW. ANY CHANGES MADE TO THIS PLAN WITHOUT THE KNOWLEDGE OF THE SURVEYOR INVALIDATES THESE DECLARATIONS.
- TO THE BEST OF MY KNOWLEDGE AND BELIEF THIS MAP IS SUBSTANTIALLY CORRECT AS NOTED HEREON.

PETER D. FLYNN CT.L.S. #8792 DATE: 6/23/03  
NOT VALID UNLESS ORIGINAL SIGNATURE, LIVE SEAL, & RAISED SEAL ARE AFFIXED

FLYNN & CYR LAND SURVEYING LLC  
274 WILSON CROSS ROAD, SUITE 100  
BETHLEHEM, CONNECTICUT 06037

FLYNN Land Surveying  
Original Ink  
Drawing on Mylar

BUILDING DETAIL

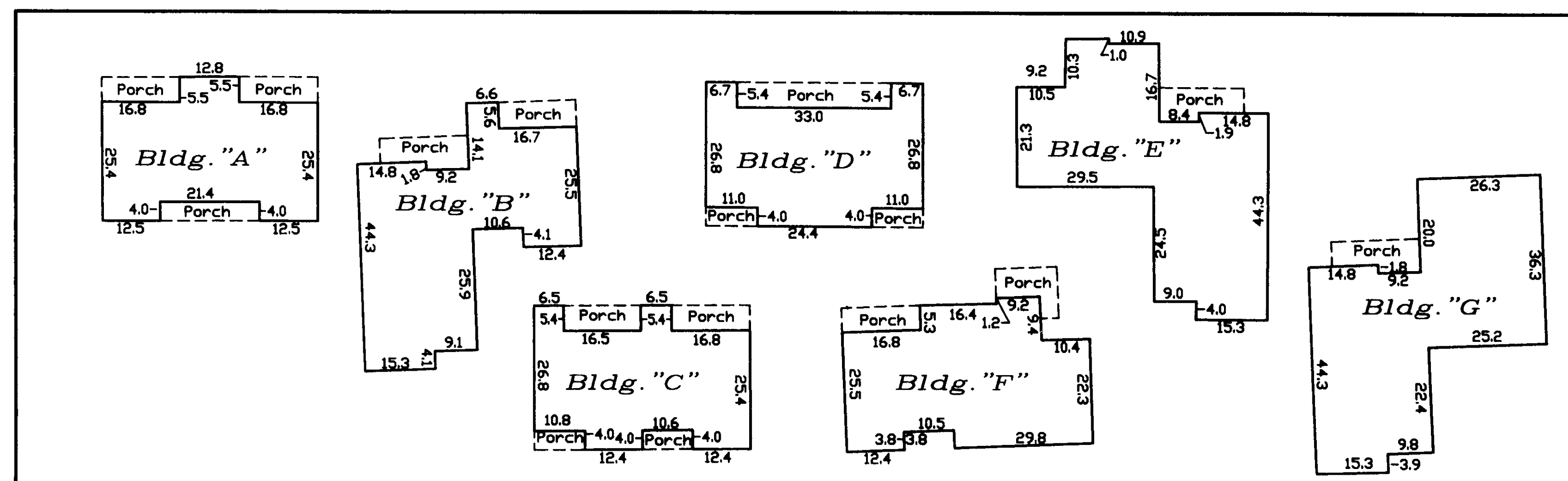

AS-BUILT SURVEY OF  
HARRIET BEECHER STOWE VILLAGE  
PROPERTY OF  
HOUSING AUTHORITY OF  
THE CITY OF HARTFORD  
PREPARED FOR  
CM DEVELOPMENT TEAM, LLC  
KENSINGTON STREET  
HARTFORD, CONNECTICUT  
SCALE 1"=30' JUNE 23, 2003  
SHEET NO. 2

