

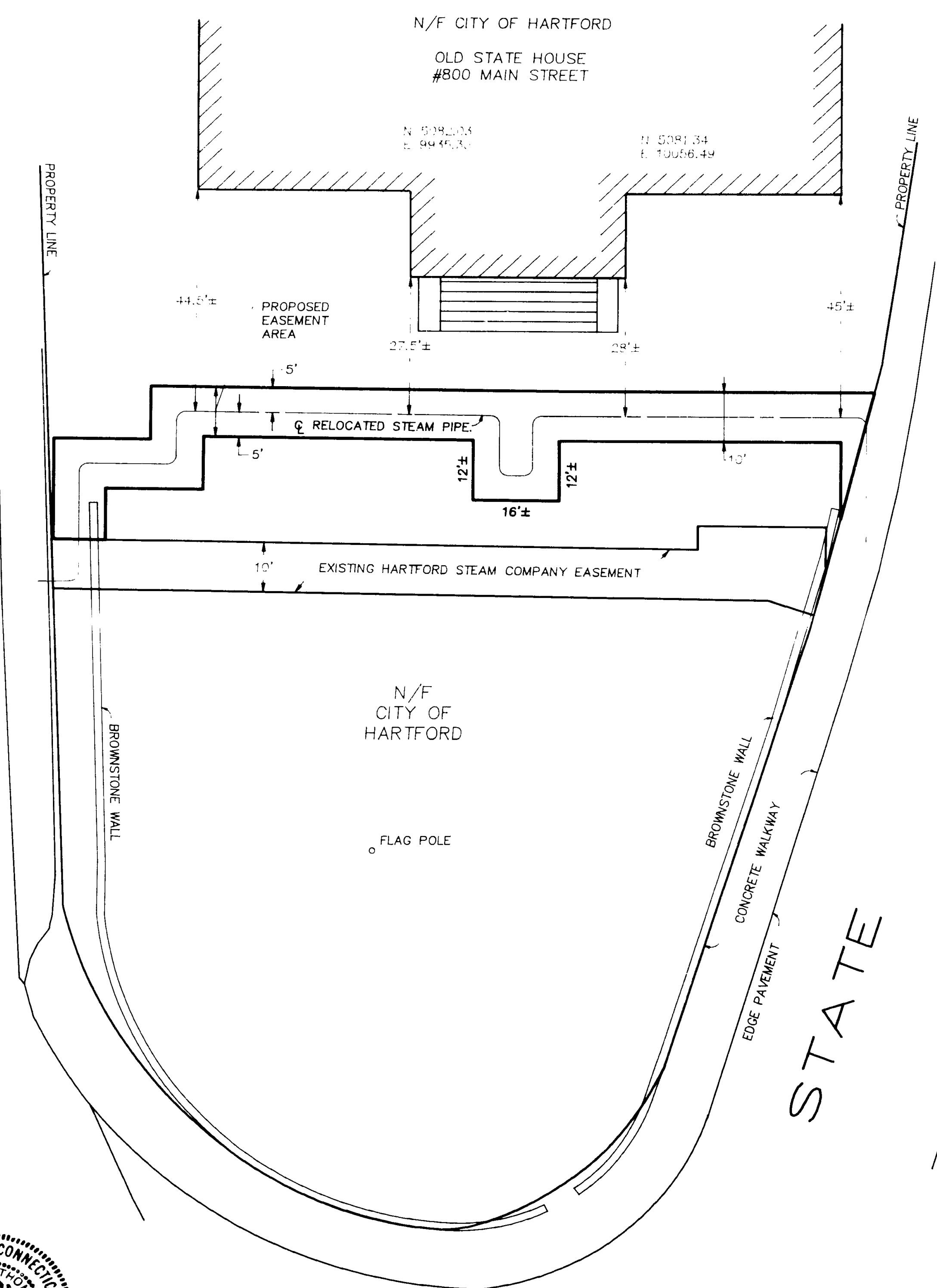

CENTRAL  
ROW

STREET

STATE



NOTE:  
EXACT LOCATION OF PROPOSED EASEMENT  
TO BE DETERMINED BY THE CENTERLINE OF  
THE RELOCATED STEAM PIPE.

MAP PRODUCED BY  
ORIGINAL DRAWING ON

PLAN SHOWING  
PROPOSED 10' HARTFORD STEAM COMPANY EASEMENT  
LOCATED FROM CENTRAL ROW  
TO STATE STREET  
THROUGH PROPERTY OF  
THE CITY OF HARTFORD  
DATE: APRIL 1993 SCALE: 1"=20'  
SARGIS ASSOCIATES, INC.  
PIPELINE SURVEYS & MAPPING

I HEREBY CERTIFY THAT THIS MAP AND SURVEY WERE PREPARED  
IN ACCORDANCE WITH THE STANDARDS OF A CLASS "D" SURVEY  
AS DEFINED IN THE CODE OF PRACTICE FOR STANDARDS OF  
ACCURACY OF SURVEYS AND MAPS, ADOPTED DECEMBER 10, 1975  
AS AMENDED BY THE CONNECTICUT ASSOCIATION OF LAND  
SURVEYORS, INC.  
*John L. Thomson*  
JOHN L. THOMSON, L.S.  
DATE 4-27-93

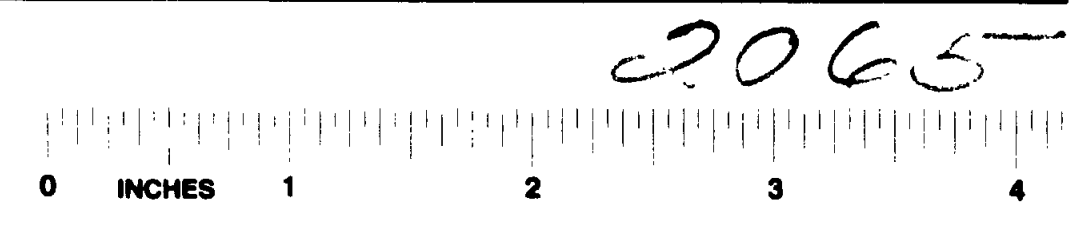
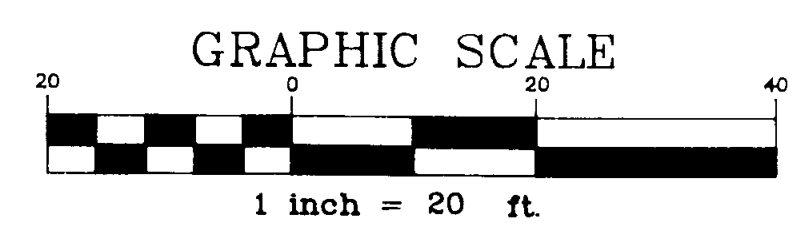
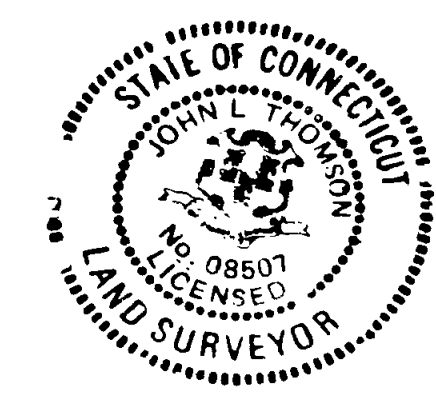

2065