

Lot 2, 3 & 4, P.M. 31
Dated 10/1/98
By: [Signature]

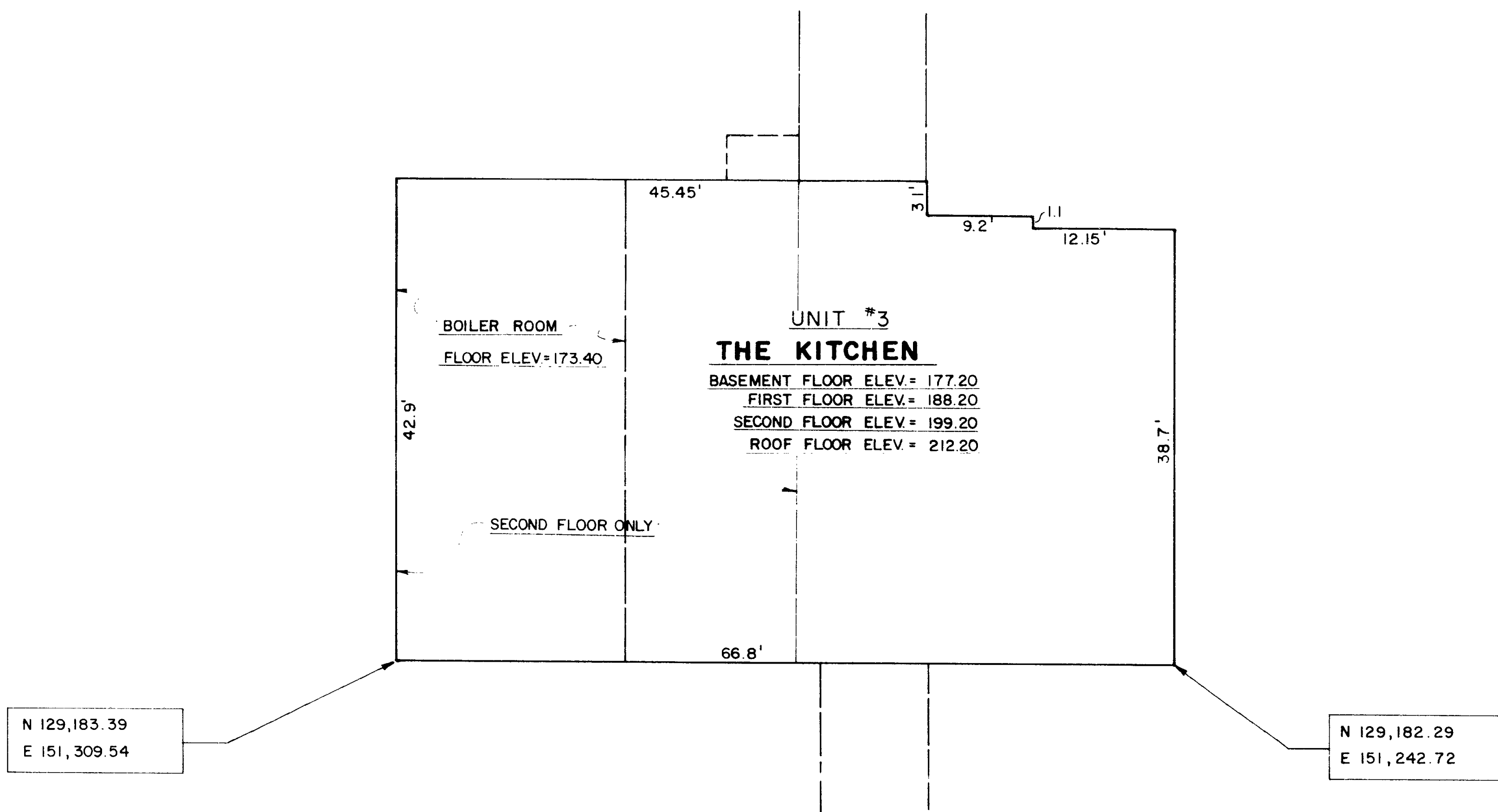

COMMONWEALTH LAND TITLE INSURANCE COMPANY
CONNECTICUT DEVELOPMENT AUTHORITY &
I hereby certify to CHURCH HOME, INC. CONGREGATIONAL
that this survey was actually made upon the ground on 10/18/98 and
that it and the bounds and measurements shown hereon are correct
within the standards of a Class A-E survey as defined in the Code
of Practice for Standards of Accuracy of Surveys and Maps, adopted
December 10, 1975, and as amended by the Connecticut Association of
Land Surveyors, Inc. and that, unless otherwise shown, deed lines
and lines of actual possession are the same, buildings are located
as shown and do not encroach over or upon street, deed or building
lines, there are no violations of zoning regulations with reference
to the location of said buildings, and there are no easements or
encroachments affecting this property apparent from a careful in-
spection of the same, other than those noted and depicted hereon
CLOSE, JENSEN & MILLER
Civil Engineers & Surveyors
[Signature]

TOTAL FLOOR AREA = 7,143 Sq. Ft.

Exhibit A-4

I hereby certify that this map and survey were
prepared in accordance with the standards of
a Class A-E survey as defined in the Code of
Practice for Standards of Accuracy of Surveys
and Maps, adopted December 10, 1975, and as
amended by the Connecticut Association of
Land Surveyors, Inc. and that this survey
contains all the information required of a
survey under Connecticut General Statutes
section 47-519 (Common Interest Ownership Act).

CLOSE, JENSEN & MILLER
Civil Engineers & Surveyors
By: [Signature]

No. Date Description Revisions		C. J. M. Close, Jensen & Miller Consulting Engineers, Land Planners & Surveyors 1137 Silas Deane Highway Wethersfield, Connecticut 06109		Designed Drawn J.S.P. Checked P.W.H. Scale 1/8" = 1'-0" Date Oct. 1998	
No. Date Description Revisions		Avery Heights 705 New Britain Avenue Hartford Connecticut		Sheet No. 11 of 11 Job No. 35613 File No. M2947	

