

LEGEND
P - PARKING STALL
W - UNDERGROUND WATER
G - UNDERGROUND GAS
E - UNDERGROUND ELECTRIC
T - UNDERGROUND TELEPHONE
S - SANITARY SEWER
DATUM MDC

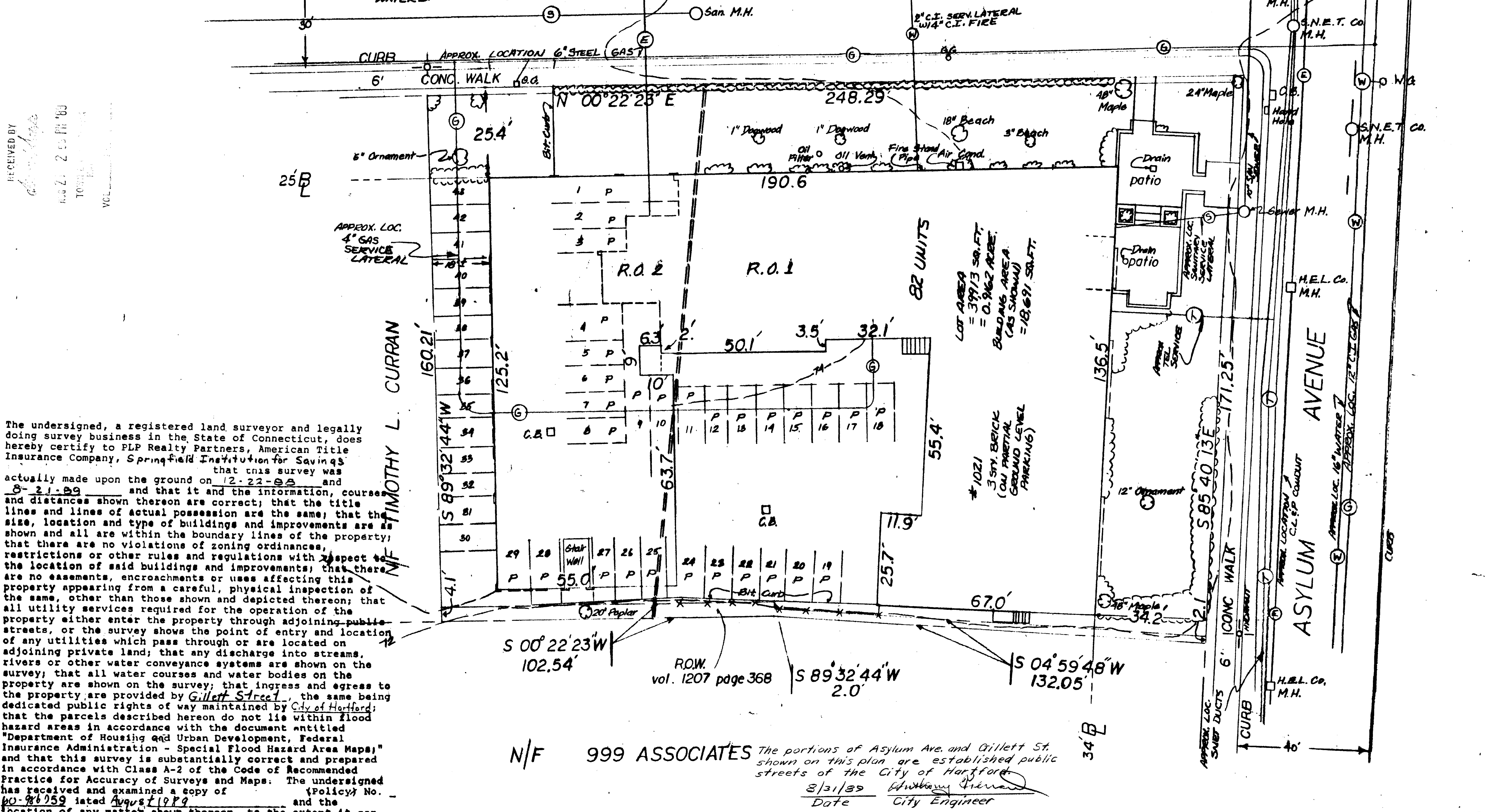

The undersigned, a registered land surveyor and legally doing survey business in the State of Connecticut, does hereby certify to PLP Realty Partners, American Title Insurance Company, Springfield Institution for Savings that this survey was actually made upon the ground on 12-22-88 and that it and the information, courses and distances shown thereon are correct; that the title lines and lines of actual possession are the same; that the size, location and type of buildings and improvements are shown and all are within the boundary lines of the property; that there are no violations of zoning ordinances, restrictions or other rules and regulations with respect to the location of said buildings and improvements; that there are no easements, encroachments or uses affecting this property appearing from a careful, physical inspection of the same, other than those shown and depicted thereon; that all utility services required for the operation of the property either enter the property through adjoining public streets, or the survey shows the point of entry and location of any utilities which pass through or are located on adjoining private land; that any discharge into streams, rivers or other water conveyance systems are shown on the survey; that all water courses and water bodies on the property are shown on the survey; that ingress and egress to the property are provided by Gillett Street, the same being dedicated public rights of way maintained by City of Hartford; that the parcels described hereon do not lie within flood hazard areas in accordance with the document entitled "Department of Housing and Urban Development, Federal Insurance Administration - Special Flood Hazard Area Maps;" and that this survey is substantially correct and prepared in accordance with Class A-2 of the Code of Recommended Practice for Accuracy of Surveys and Maps. The undersigned has received and examined a copy of (Policy) No. 10-81252 dated August 1989 and the location of any matter shown thereon, to the extent it can be located, has been shown hereon with the appropriate recording reference.

Carl H. Jaeger L.S. 7763 8-21-89

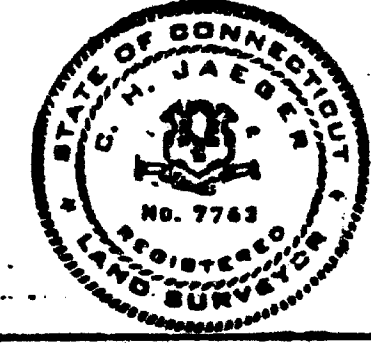

N/F 999 ASSOCIATES The portions of Asylum Ave. and Gillett St. shown on this plan are established public streets of the City of Hartford.
3/31/89 Date City Engineer

PROPERTY OF
PLP REALTY PARTNERS
EXECUTIVE HOUSE
1021 ASYLUM AVE.
TOWN OF HARTFORD CONN.

I HEREBY CERTIFY
THAT THIS MAP & SURVEY WERE PREPARED IN ACCORDANCE WITH THE STANDARDS OF CLASS A-2 SURVEY AS DEFINED IN THE CODE OF PRACTICE FOR STANDARDS AND ACCURACY OF SURVEY & MAPS ADOPTED DECEMBER 10, 1975 AS AMENDED BY THE CONN. ASSOCIATION OF LAND SURVEYORS, INC.

ALCA SURVEY ASSOCIATES
CARL H. JAEGER L.S. 7763
WETHERSFIELD, CONN.
SCALE 1" = 20'
DATE 8-21-89
SHEET 1 OF 1
UPDATED 8-21-89

