

- NOTES:
- 1) REFERENCE FOR AZIMUTH USED IS METROPOLITAN DISTRICT COMMISSION COORDINATE SYSTEM.
  - 2) REFERENCE IS MADE TO OUR 40 SCALE BLOCK MAPS (2 SHEETS) SHOWING THE ENTIRE CONGRESS STREET COMMUNITY AREA.
  - 3) IRON PINS OR OTHER APPROPRIATE MARKERS TO BE SET AT CORNERS.

NOTE: ACCESS EASEMENT TO DEAN ST. (TO BE RECORDED)

HISTORIC HARTFORD HOUSING ASSOCIATES  
N 78°-34'-23" E  
60.00'

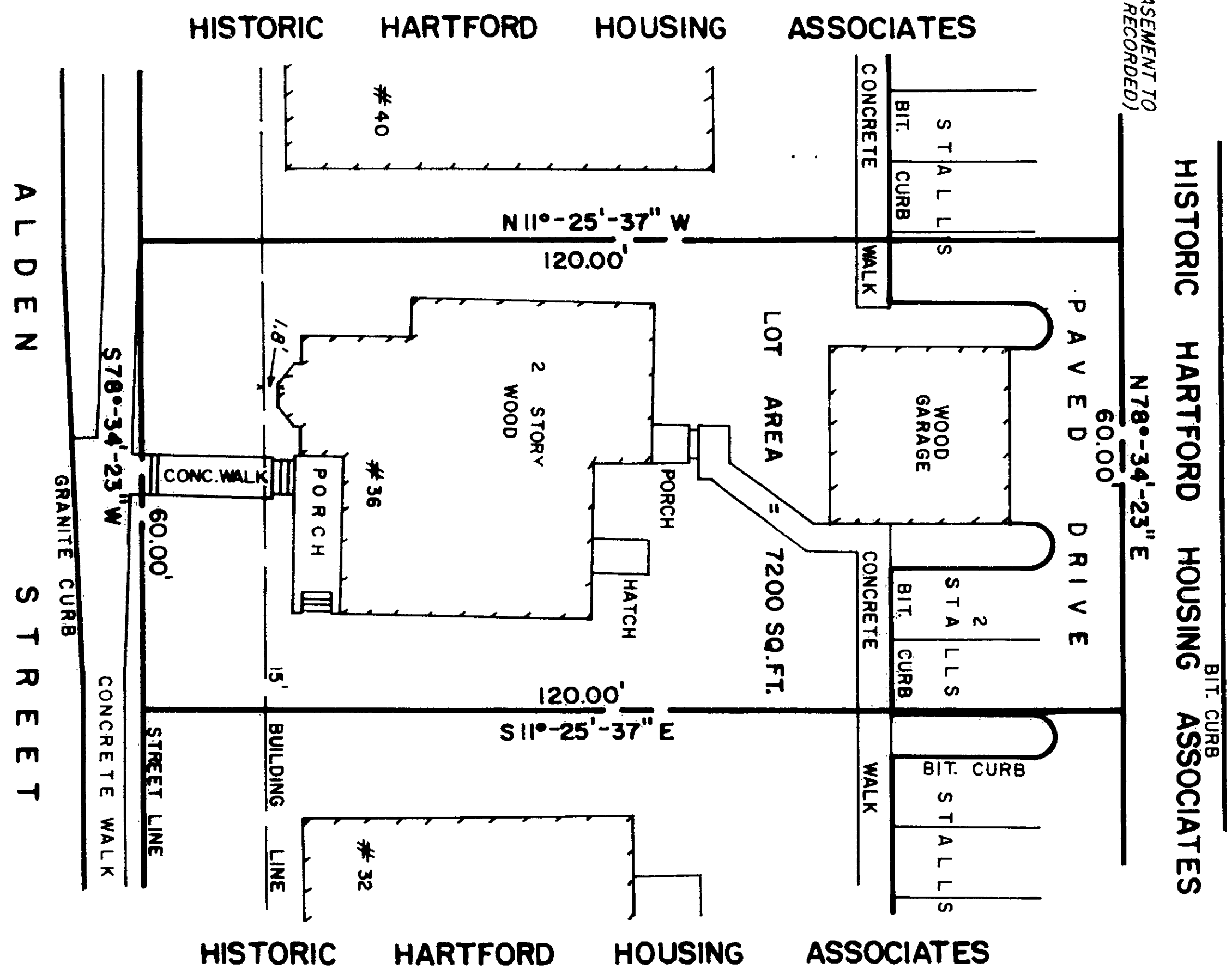

ALDEN STREET

The portion of Alden St shown on this plan is an established public street of the City of Hartford.  
3/30/87  
Date  
City Engineer

TO: CONGRESS STREET CONDOMINIUMS, LTD.; ADVEST BANK; AND LAWYERS TITLE INSURANCE CORPORATION.  
WHEREBY, THE SURVEYOR HAS ACCURATELY MADE A RECONSTRUCTION OF THE SURVEYED LOTS AND BUILDINGS AND MEASUREMENTS SHOWN HEREON ARE CORRECT WITHIN THE STANDARDS OF CLASS A-2 OF THE SURVEYORS ASSOCIATION OF CONNECTICUT, AND THAT, UNLESS OTHERWISE SHOWN, TITLE LINES AND LINES OF ACTUAL POSSESSION ARE THE SAME, AND NO ENCROACHMENT UPON STREET OR BUILDING LINES, THERE ARE NO VIOLATIONS OF ZONING REGULATIONS, WITH REFERENCE TO THE LOCATION OF SAID BUILDINGS, AND THERE ARE NO EASEMENTS OR ENCROACHMENTS AFFECTING THIS PROPERTY APARTMENT FROM A CAREFUL INSPECTION OF THE SAME

FEB 9, 1987

E. J. Smith



MAP PREPARED BY:  
PETERSEN & HOFFMAN — LAND SURVEYORS  
1000 FARMINGTON AVE, WEST HARTFORD, CT 06107

CONGRESS STREET COMMUNITY  
36 ALDEN STREET  
HARTFORD, CONNECTICUT  
SCALE: 1 IN. = 20 FT. FEB, 1987

VOL. 11  
TOWN OF HARTFORD  
FEB 11 10 55 AM '87  
PAGE 1

0 1 2 3 4  
INCHES

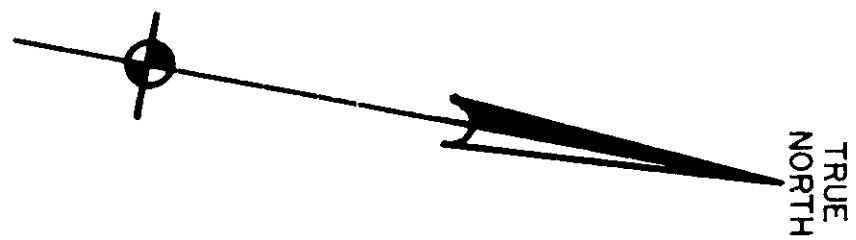

EASI FILE CORP IRVINE CA EFM 34  
1616