

EASI FILE CORP IRVINE CA EPH 34  
**1279**

**1279-3**

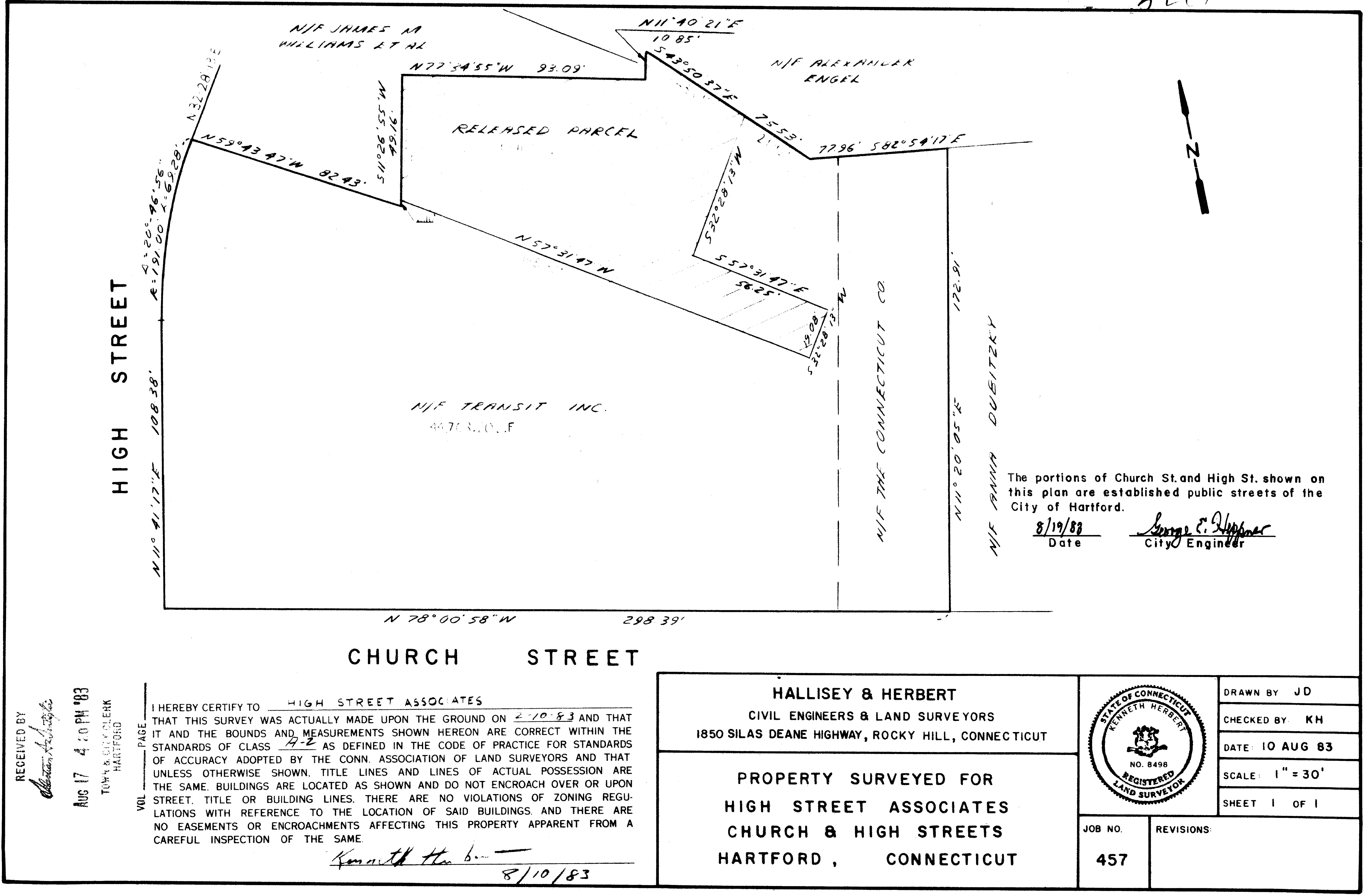

RECEIVED BY  
*George E. Herbert*  
AUG 17 4 20 PM '83  
TOWN & CITY CLERK  
HARTFORD

I HEREBY CERTIFY TO HIGH STREET ASSOCIATES  
THAT THIS SURVEY WAS ACTUALLY MADE UPON THE GROUND ON 2-10-83 AND THAT  
IT AND THE BOUNDS AND MEASUREMENTS SHOWN HEREON ARE CORRECT WITHIN THE  
STANDARDS OF CLASS A-2 AS DEFINED IN THE CODE OF PRACTICE FOR STANDARDS  
OF ACCURACY ADOPTED BY THE CONN. ASSOCIATION OF LAND SURVEYORS AND THAT  
UNLESS OTHERWISE SHOWN, TITLE LINES AND LINES OF ACTUAL POSSESSION ARE  
THE SAME. BUILDINGS ARE LOCATED AS SHOWN AND DO NOT ENCROACH OVER OR UPON  
STREET, TITLE OR BUILDING LINES. THERE ARE NO VIOLATIONS OF ZONING REGU-  
LATIONS WITH REFERENCE TO THE LOCATION OF SAID BUILDINGS, AND THERE ARE  
NO EASEMENTS OR ENCROACHMENTS AFFECTING THIS PROPERTY APPARENT FROM A  
CAREFUL INSPECTION OF THE SAME.  
*George E. Herbert*  
8/10/83

<b>HALLISEY &amp; HERBERT</b> CIVIL ENGINEERS & LAND SURVEYORS 1850 SILAS DEANE HIGHWAY, ROCKY HILL, CONNECTICUT	
<b>PROPERTY SURVEYED FOR</b> <b>HIGH STREET ASSOCIATES</b> <b>CHURCH &amp; HIGH STREETS</b> <b>HARTFORD, CONNECTICUT</b>	
JOB NO. <b>457</b>	REVISIONS:

	DRAWN BY: <b>JD</b>
	CHECKED BY: <b>KH</b>
	DATE: <b>10 AUG 83</b>
	SCALE: <b>1" = 30'</b>
	SHEET <b>1</b> OF <b>1</b>

