

RECEIVED  
HARTFORD, CONN.  
MAR 3 8 52 AM '64  
JOHN R. GILLEN  
TOWN ENGINEER

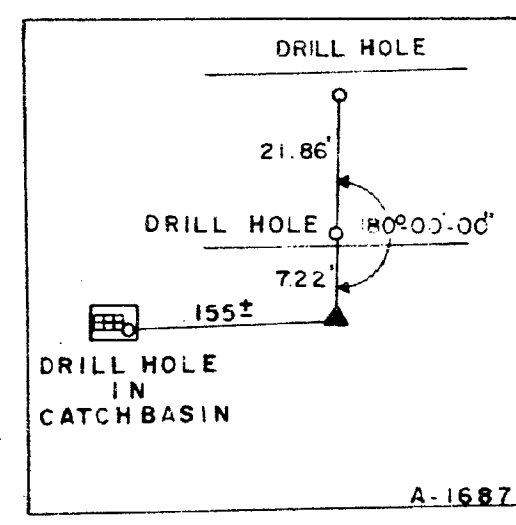
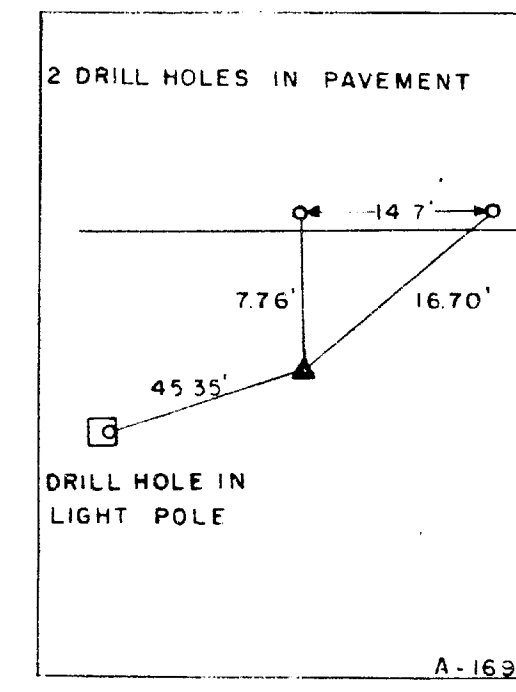
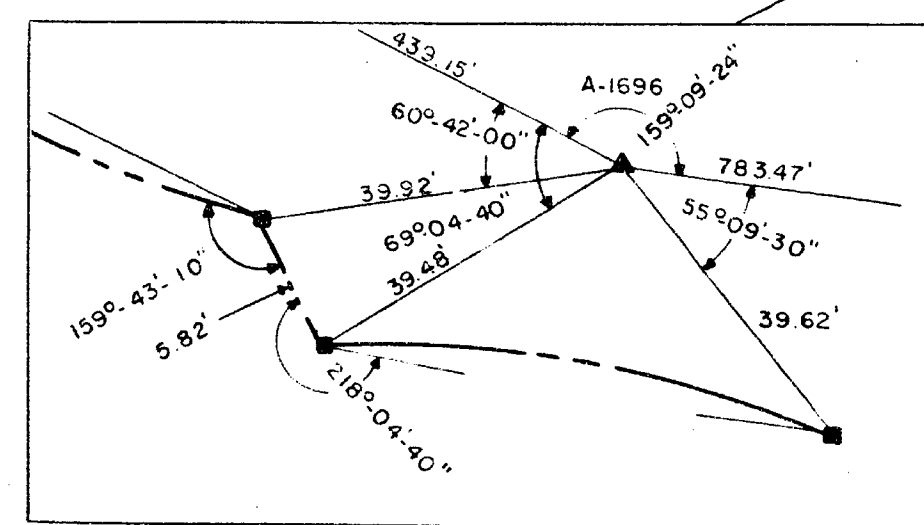
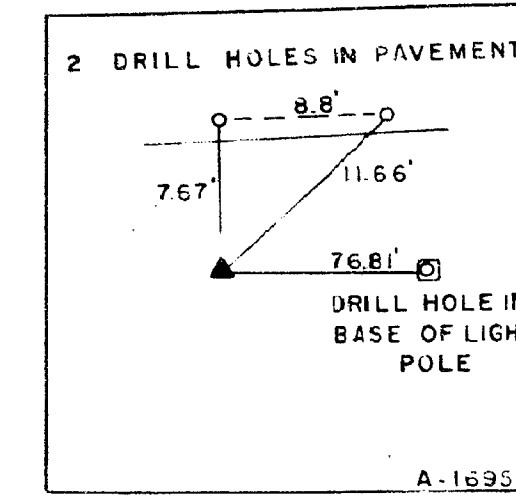
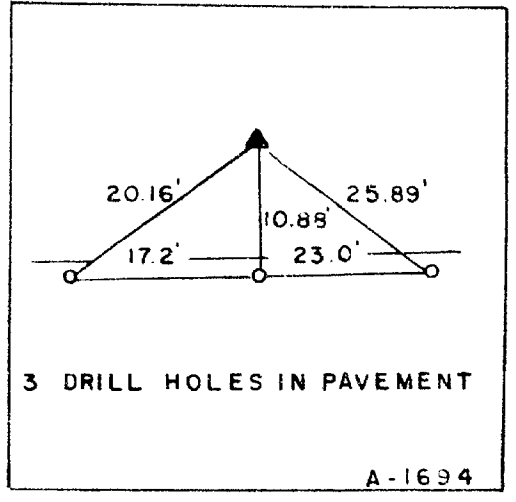
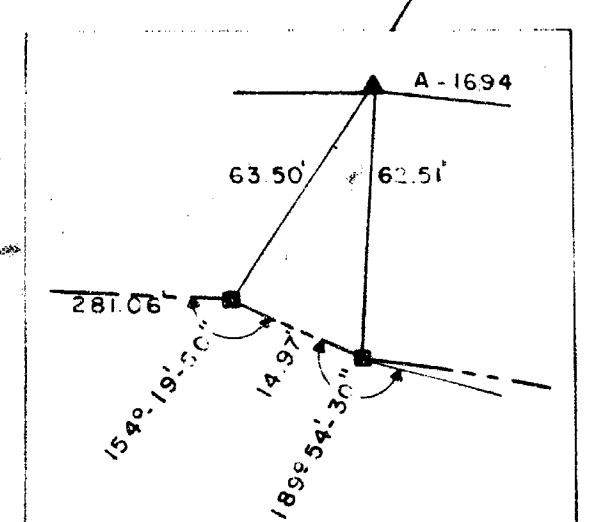
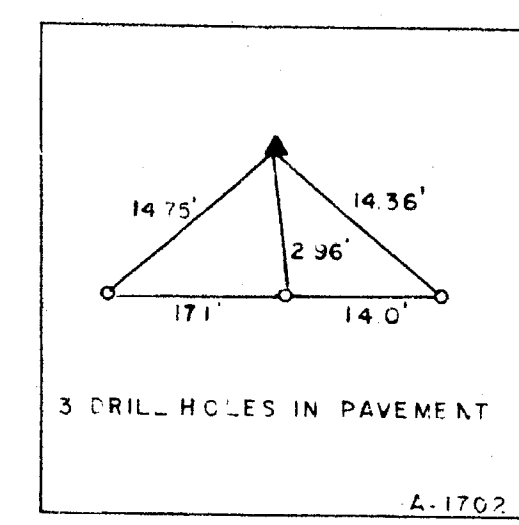
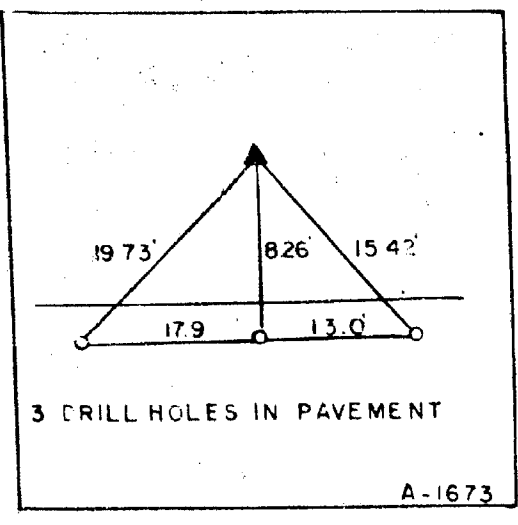
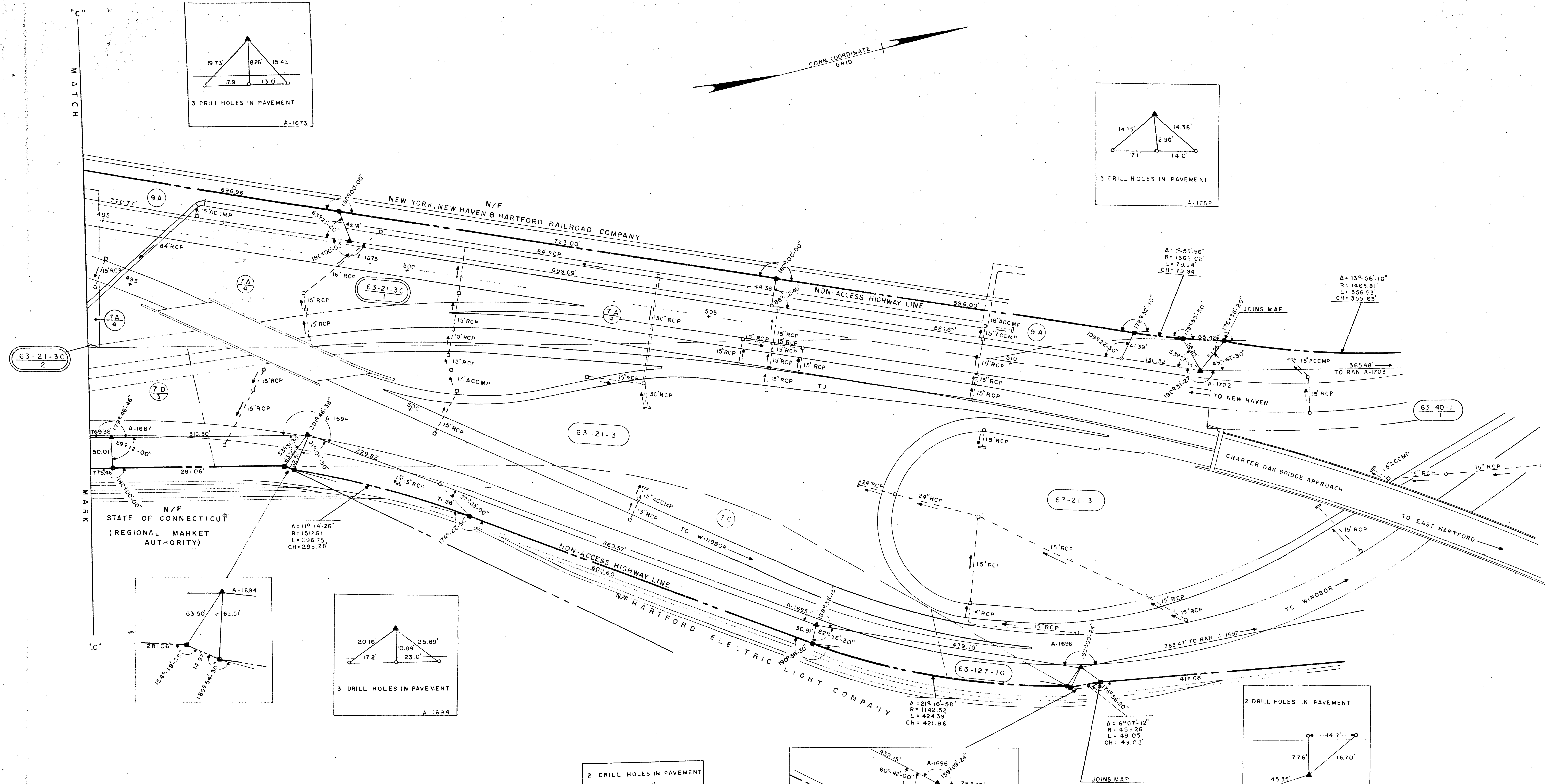

THIS MAP SUPERSEDES A PORTION OF MAP 63-04 SH.2 & SH.3 DATED APRIL 1, 1958

TOPOGRAPHY AND OWNERSHIP BASED ON 1961 CONSTRUCTION PLANS

PARCEL NUMBERS, UNLESS OTHERWISE NOTED, REFER TO CONSTRUCTION PROJECT 118-68 STATION NUMBERS REFER TO CONSTRUCTION PROJECT 159-91

COORDINATES SHOWN ON THIS MAP REFER TO THE CONNECTICUT COORDINATE SYSTEM.

THIS MAP CONFORMS TO CLASS A1 OF CODE OF CONNECTICUT TECHNICAL COUNCIL, INC.

- LEGEND**
- HIGHWAY BOUNDARY STONE
  - ANCIENT OR LOCAL STONE ON LINE
  - ▲ BASE LINE SURVEY STONE
  - IRON PIN, PIPE OR BRASS PIN
  - HIGHWAY BOUNDARY LINE
  - TREES: OAK, FIR, OTHERS
  - UTILITY POLE
  - WIRE FENCE
  - BOARD FENCE
  - PICKET FENCE
  - VIRGINIA RAIL FENCE
  - RETAINING WALL
  - STONE WALL
  - HEDGE

APPROVED *Edward J. Sullivan*  
ENGINEER OF BOUNDARY SURVEYS

APPROVED HOWARD S. IVES  
STATE HIGHWAY COMMISSIONER

DATE DECEMBER 18, 1964  
I hereby certify that this map is substantially correct to the best of my knowledge and belief.

*Benjamin P. Lenda*  
ENGINEER

CONNECTICUT STATE HIGHWAY DEPARTMENT	
RIGHT OF WAY MAP	
TOWN OF HARTFORD	
HARTFORD - NEW HAVEN EXPRESSWAY	
FROM WETHERSFIELD TOWN LINE NORTHERLY TO CHARTER OAK BRIDGE	
SCALE 1"=80'	NUMBER 63-05
SURVEY BY B. LENDA & G. PANELLA	DATE 6-63
PLOTTED BY J. PUGLISI	DATE 9-63
TRACED BY S. DONAHUE	DATE 4-64
APPROVED B. LENDA	DATE 6-64
SHEET NO. 4 OF 4	

