

452-2

RECEIVED
HARTFORD, CONN.

FEB 16 10 41 AM '59

WILLIAM A. LINNANE
TOWN & CITY CLERK

The portion of
Victoria Road
shown on this plan
is an established
public street of
the City of
Hartford.

Feb. 17, 1959

Winifred W. Dillay
City Engineer

Prop. Manual
Sluice Gate

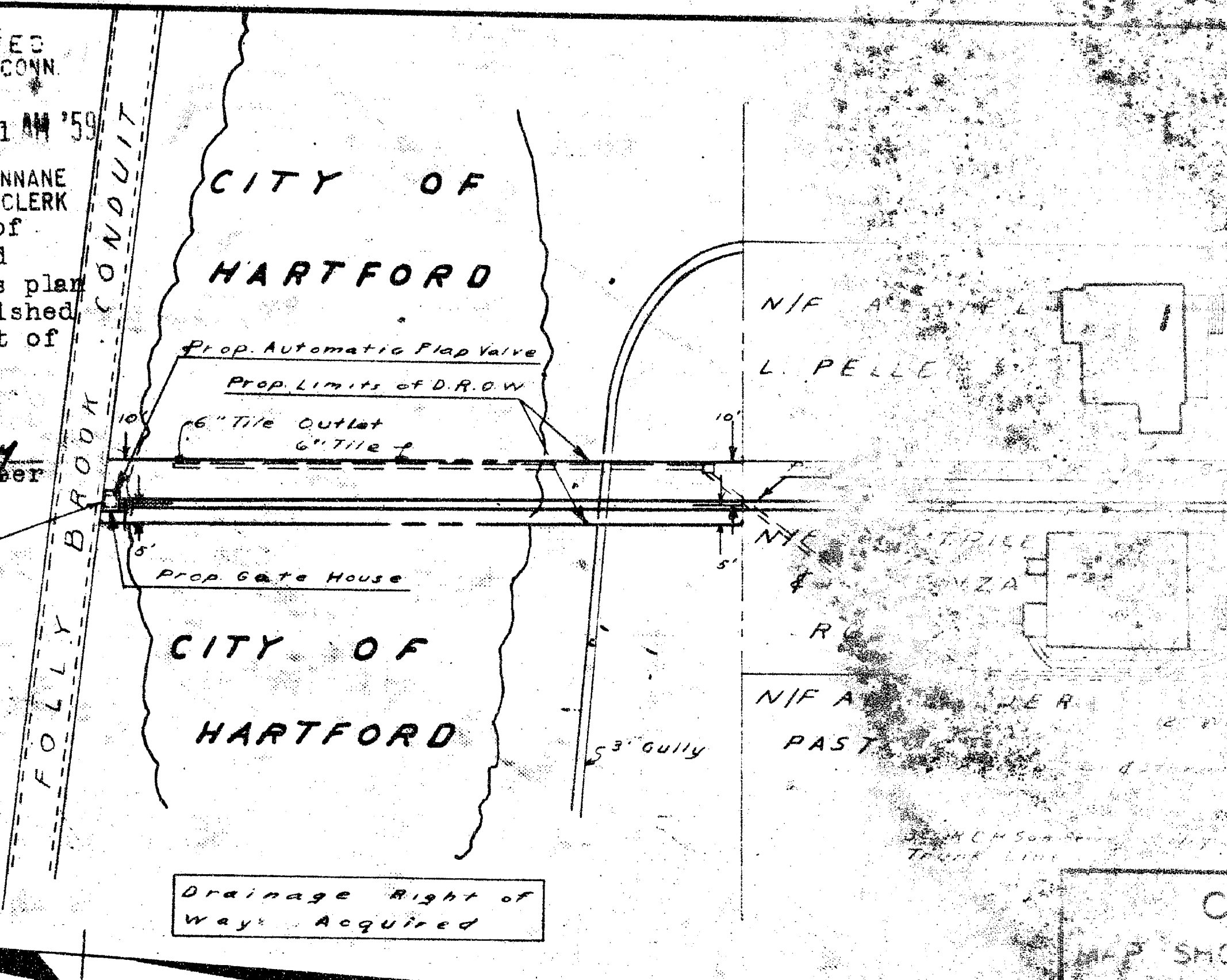

Drainage Right of
Way Acquired

THIS MAP CONFORMS TO CLASS D
OF CODE OF CONNECTICUT
TECHNICAL COUNCIL, INC.

TOWN NO. 63

PROJECT NO. MISC

SERIAL NO.

SHEET 1 OF 1

I HEREBY CERTIFY THAT THIS MAP
IS SUBSTANTIALLY CORRECT TO THE
BEST OF MY KNOWLEDGE AND BELIEF.

Robert J. Mitchell
Engineer of Traffic
TITLE *Planning Design*

DATE *September 1956*

CITY OF HARTFORD
MAP SHOWING EASEMENT ACROSS
CITY OF HARTFORD

STATE OF CONNECTICUT
VICTORIA ROAD & WOLCOTT HIGHWAY
STATE HIGHWAY

Notary Public
HIGHWAY COMMISSIONER

